

BUILT ON PRINCIPLES



Hansen

J P NAGAR 8TH PHASE





## AT ARYA, QUALITY HAS NO FINISH LINE

We believe there are no boundaries for quality. That's why our constant pursuit is to achieve uncompromising standards in what we deliver. From quality of material and quality of finish to architectural design and added values – every detail has been given the highest care. Including Vaastu Compliance.

So when you walk into Arya Hamsa at J P Nagar 8th Phase, Bangalore, you be the judge. You do the inspection. And admittedly, you'll end up pleasantly surprised with all your discoveries.





## TESTED AT EVERY STAGE

Arya Hamsa is distinctive from the word go. A variety of critical quality tests are done at regular intervals on site – before and during the construction. These are done both internally and through external agencies to ensure the highest quality standards.



### 1 WATER TEST

The water available on site is tested for suitability of construction.

### 2 SAND TEST

The sand is tested for silt content and untested sand is not used for construction.

### 3 CONCRETE BLOCKS TEST

Concrete blocks are tested for strength.

### 4 CONCRETE MIX TEST

The scientific method of weigh batching is followed for mixing the concrete (cement, sand and granite). Volumetric pan-measure methods are not used. The concrete is later tested for strength.

### 5 STEEL TEST

An external certifying body tests our steel for physical and chemical properties. Only virgin steel is used, not re-rolled steel.

### 6 CEMENT TEST

Cement is tested by an external certifying body for various aspects including setting time, fineness and chemical properties.

### 7 PIPELINES TEST

Pressure testing is done to ensure leakage-free plumbing lines.

### 8 TILES TEST

Tiles are tested for abrasion, wear and tear and better durability.

### 9 WIRES TEST

The wires are tested to make sure they carry the right load and comply to the ISI standards.

### 10 DOOR TEST

The wood used for doors is checked for withstanding temperature changes, effect of humidity and resistance to water.





## LIVE ON LIGHT AND FRESH AIR

Arya Hamsa consists of five towers of seven storeys each. Every home is designed for healthy living with ample ventilation and plenty of sunlight. Put your feet up, take a deep breath and enjoy!







## **CLUBHOUSE**

The Clubhouse has been built and is ready. It is a common facility for Arya Hamsa and Arya Hamsa Grande projects. Equipped to serve your needs with snooker, badminton, tennis, multi-purpose hall and swimming pool.







## WATER THERAPY

A full-sized swimming pool with a toddler's pool is all you'll need to soothe your tired nerves. Be it a weekday or weekend.

## PLAN BEFORE YOU MAKE YOUR MOVE

Total area: 3 acres

No. of apartments: 245

Classification: Premium Luxury Apartments

Size: 1/2/3 BHK, 728 Sft - 1518 Sft

As you scan through our plans, you'll realise that they've been designed for you. Giving utmost importance to your comforts and your privacy. After all, it's the space where you want to spend the rest of your life.

## MASTER PLAN

- |                                 |   |
|---------------------------------|---|
| 1. 40 Feet Wide Road            | 14. Shopping Area (Stilt and G.F.)              |
| 2. Entry / Exit                 | 15. 3 Bedroom Unit                              |
| 3. Terrace Garden (G.F.)        | 16. 2 Bedroom Unit                              |
| 4. Swimming Pool*               | 17. Studio Unit                                 |
| 5. Swimming Pool Desk*          | 18. Block 4                                     |
| 6. Driveway with Grass Pavers   | 19. Block 3                                     |
| 7. Ramp Up                      | 20. Block 2                                     |
| 8. Tennis Court*                | 21. Block 1                                     |
| 9. Ramp Up                      | 22. Block 5                                     |
| 10. Fire Driveway / Green Space | 23. Auditorium*                                 |
| 11. Entry                       | 24. Multipurpose Hall (S.F.) & Gymnasium (F.F)* |
| 12. Area Below H.T.L.           | 25. Badminton Court*                            |
| 13. 50 Feet Wide Road           |   |

\*Common facility for Arya Hamsa and Arya Hamsa Grande





FLOOR	Typical			
TYPE	H - 2 bhk	I - 2 bhk	J - 3 bhk	K - 2 bhk
SBA	1255	1118	1430	1120
TERRACE	Ground			

### FLOOR PLAN Block 1

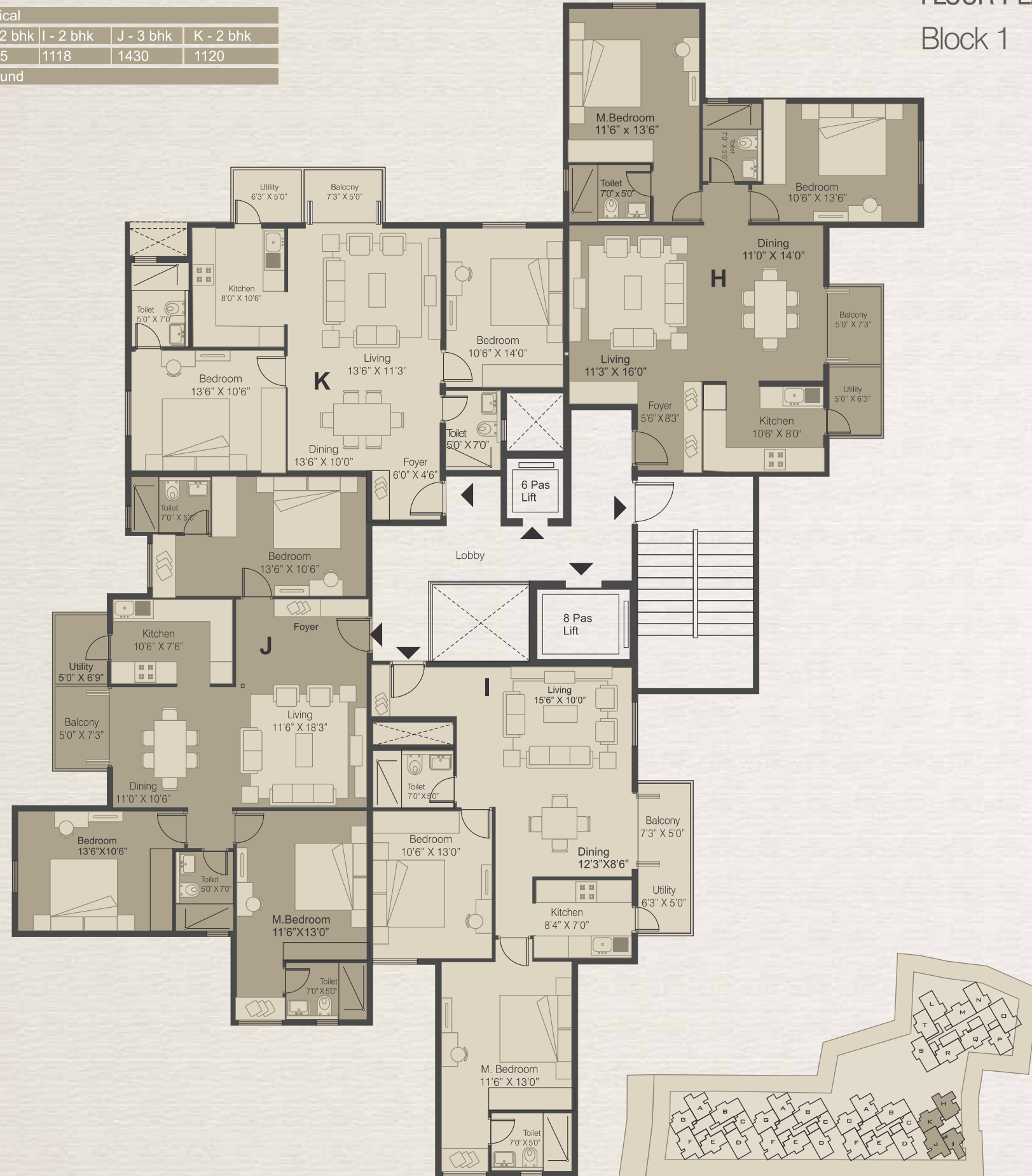

### FLOOR PLAN Block 2, 3, 4

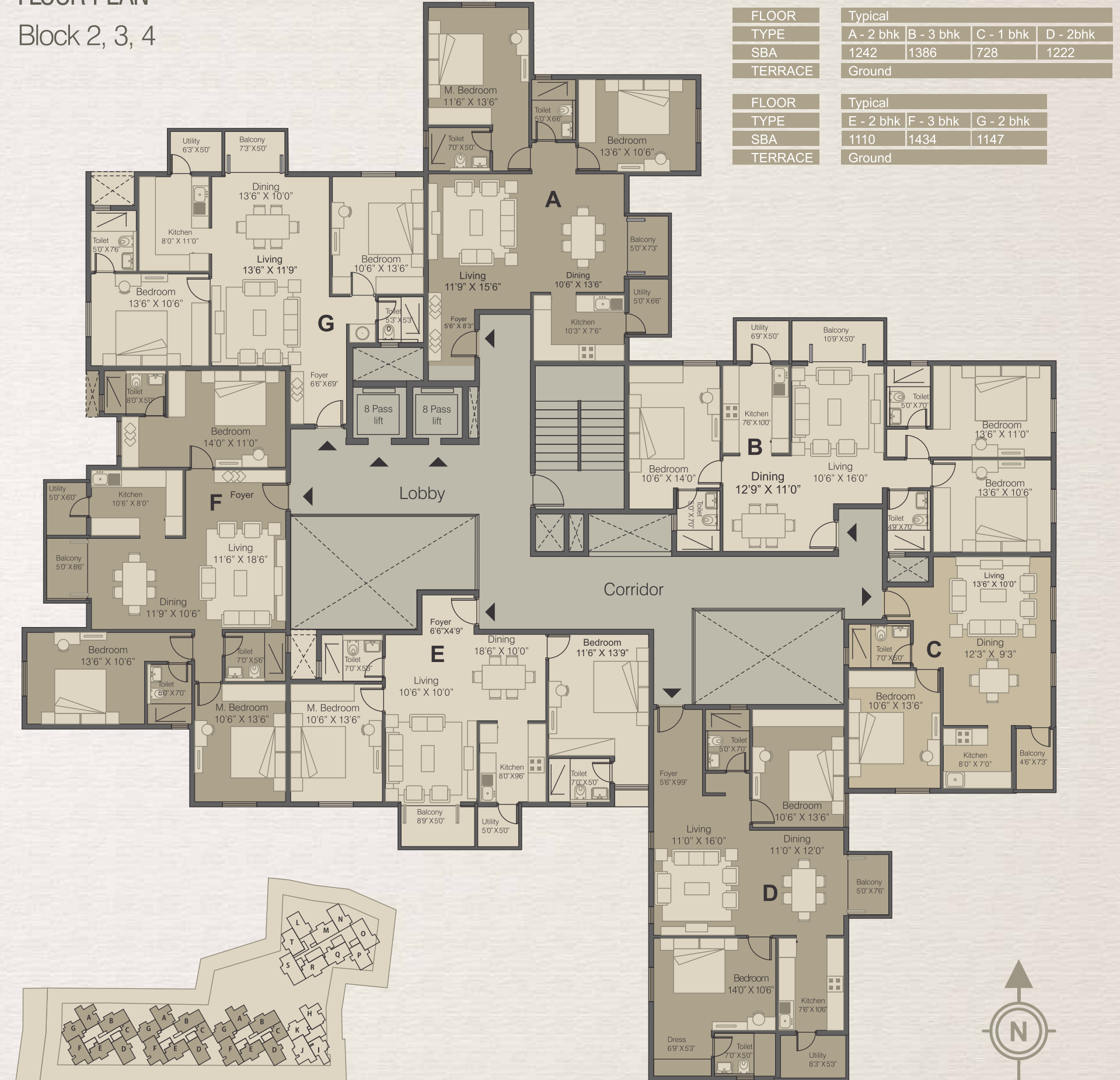

FLOOR	Typical			
TYPE	A - 2 bhk	B - 3 bhk	C - 1 bhk	D - 2bhk
SBA	1242	1386	728	1222
TERRACE	Ground			

FLOOR	Typical		
TYPE	E - 2 bhk	F - 3 bhk	G - 2 bhk
SBA	1110	1434	1147
TERRACE	Ground		



# FLOOR PLAN

## Block 5: Type R

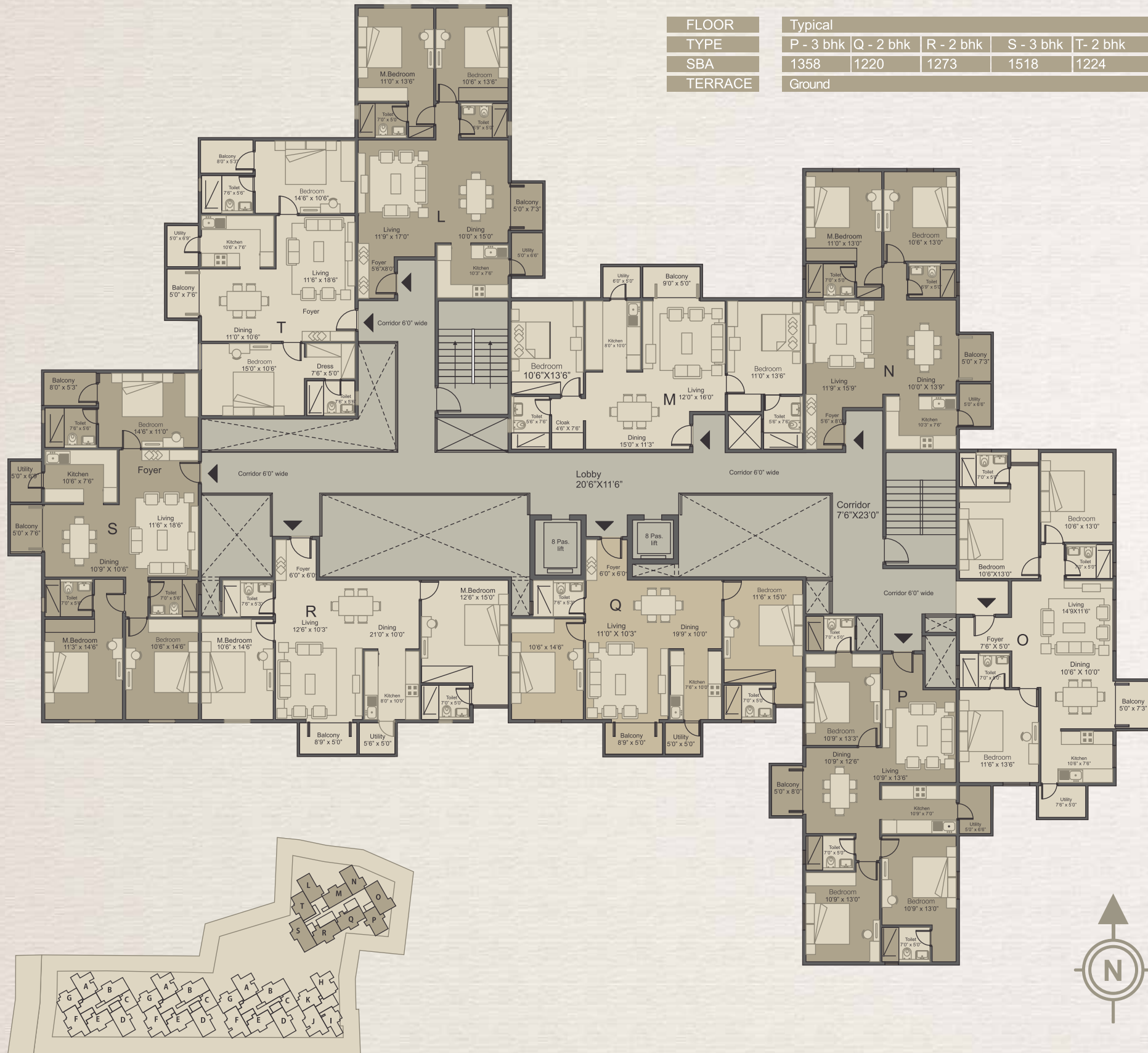

FLOOR	Typical			
TYPE	L - 2 bhk	M - 2 bhk	N - 2 bhk	O - 3 bhk
SBA	1264	1235	1212	1468
TERRACE	Ground			

FLOOR	Typical				
TYPE	P - 3 bhk	Q - 2 bhk	R - 2 bhk	S - 3 bhk	T - 2 bhk
SBA	1358	1220	1273	1518	1224
TERRACE	Ground				

# SPECIFICATIONS

## STRUCTURE

RCC framed structure conforming to IS codes for earthquake & wind loads. External & Internal walls of solid concrete blocks. External walls with cement plaster & internal walls with cement plaster, finished smooth with lime.

## FLOORING

Vitrified tiles for living and dining. Bedrooms & kitchens. Anti-skid tiles for toilets & balconies.

## LOBBY & STAIRCASE

A combination of granite and unpolished vitrified tiles. Granite with vitrified cladding for lift facia.

## DOORS & WINDOWS

**Main doors:** Teak wood frame with HDF moulded design shutter.

**Internal doors:** Hardwood frame with HDF moulded design shutters.

**Windows:** UPVC sliding windows.

## KITCHEN

Glazed tile dadoing of 2ft above kitchen counter. Provision for chimney / exhaust.

## TOILETS

Anti-skid tile flooring and glazed tile dadoing up to 7'6" height. Sanitary ware of Parry or equivalent make. Chrome plated taps of Jaguar or equivalent make. False ceiling with grid panels.

## WALL FINISHES

**Internal walls:** Oil bound distemper for all smooth walls and ceilings. **External walls:** Exterior emulsion on all rough walls.

## ELECTRICAL

Concealed conduits with copper wiring of Anchor or equivalent make. Elegant modular switches of Anchor or equivalent make.

## ELCB AND MCB FOR SAFETY

2 KVA power provided for 1 BHK, 3 KVA power for 2 BHK and 5 KVA power for 3 BHK.

## GENERATOR

Back-up power for all common services in addition to 1 KVA for 1 & 2 BHK, 1.5 KVA for 3 BHK apartments.

## WATER SUPPLY

Underground and overhead storage tanks of suitable capacity. Bore-well as an auxiliary source of water supply.

## LIFTS

Two high-speed lifts of suitable capacity for each block.

## TV & TELEPHONE

In living and master bedroom.

## SECURITY SYSTEM

Round-the-clock security with intercom facility to each apartment.

## WATER SOFTENER & SEWAGE TREATMENT PLANT

## LOCATION MAP



## CONSULTANTS

- Legal: Indus Law
- Architect: Pragrup
- Structural: Noel Consultants
- Electrical: Electromech
- Plumbing & Sanitary: Electromech
- Fire Fighting: Electromech
- Lifts: Schindler

## APPROVED BY

All leading banks including KVB, SBI, HDFC, ICICI, Axis and LIC HFL

## POSSESSION

May 2013 Onwards



## OUR COMPLETED PROJECTS



**ARYA SEVERIA**  
Mahadevapura



**ARYA LOTUS**  
Whitefield



Corporate Office:

Arya Group

#181, Intermediate Ring Road, Amarjyothi Layout

Domlur, Bangalore 560 071

Phone: +91-80-2535 7547

Email: [info@thearyagroup.in](mailto:info@thearyagroup.in)

[www.thearyagroup.in](http://www.thearyagroup.in)

Sales:

Phone: 97413 59994, 99000 81675, 080-46406999

Email: [sales@thearyagroup.in](mailto:sales@thearyagroup.in)