

LIFE IN ROYAL REGALIA
GIVES LUXURY
A WHOLE NEW MEANING



ROYAL REGALIA
PREMIUM RESIDENTIAL APARTMENTS



“THE ULTIMATE
IN LUXURY LIVING”



ROYAL REGALIA
PREMIUM RESIDENTIAL APARTMENTS





ROYAL REGALIA
PREMIUM RESIDENTIAL APARTMENTS

THE PERFECT EXAMPLE OF FINE HOMES AND NATURAL LIVING

Royal Regalia is the flagship project in Jaipur, with world-class plush amenities and the best luxury home specifications.

Grand balconies overlooking spectacular greenery, terrace garden on optional floor, lush green landscaping & water features. Creating a truly opulent and tranquil ambience to come home to.



THE ABODE OF HAPPINESS

Homes in Royal Regalia look out into incredibly breathtaking views and nestling cloud offering unrivalled space and unsurpassed privacy. Royal Regalia is an ultimate relaxing retreat with phenomenal views suits the most discerning guests who wish to reside in privileged splendor. Seek style and you will find it in plenty amid ultra modern landscaped garden for children's play area, long driveways and a blissful backdrop.

Choose your happiness from a distinctive range of 2BHK & 3BHK apartments.





THE ULTIMATE DESIGN

Royal Regalia symbolises lavishness and contemporary styling. The edifice is a blend of artistic initiative and a deep understanding of styling that unfolds a world full of choicest possibilities of opulent living.

With soothing ambience and elegant decor being its forte, the luxury apartments will uplift your mood by its proper ventilation, flow of air and sunlight. The spacious living room adjoining an elegant dining area, casts a spell of grandeur and the lavish bedrooms with the beautiful balcony exude a rare class and sophistication.

Royal Regalia will have round-the-clock security and access to enviable recreational facilities, a children's play area and much more....

LOCATION MAP

Site Address: Khasra No. 143/3, Near Gandhi Path, Vaishali Elegance, Vaishali Nagar Ext., Jaipur.

A testament to tranquility, Royal Regalia is located exactly where you would wish your home to be. Set amidst lush landscaped gardens, it is conveniently tucked in Gandhi Path (W), Vaishali Nagar. This postcard-perfect location adds star to its style of architecture that is reminiscent of tradition and modernity. **It is only 1 km. from Vaishali Nagar.**

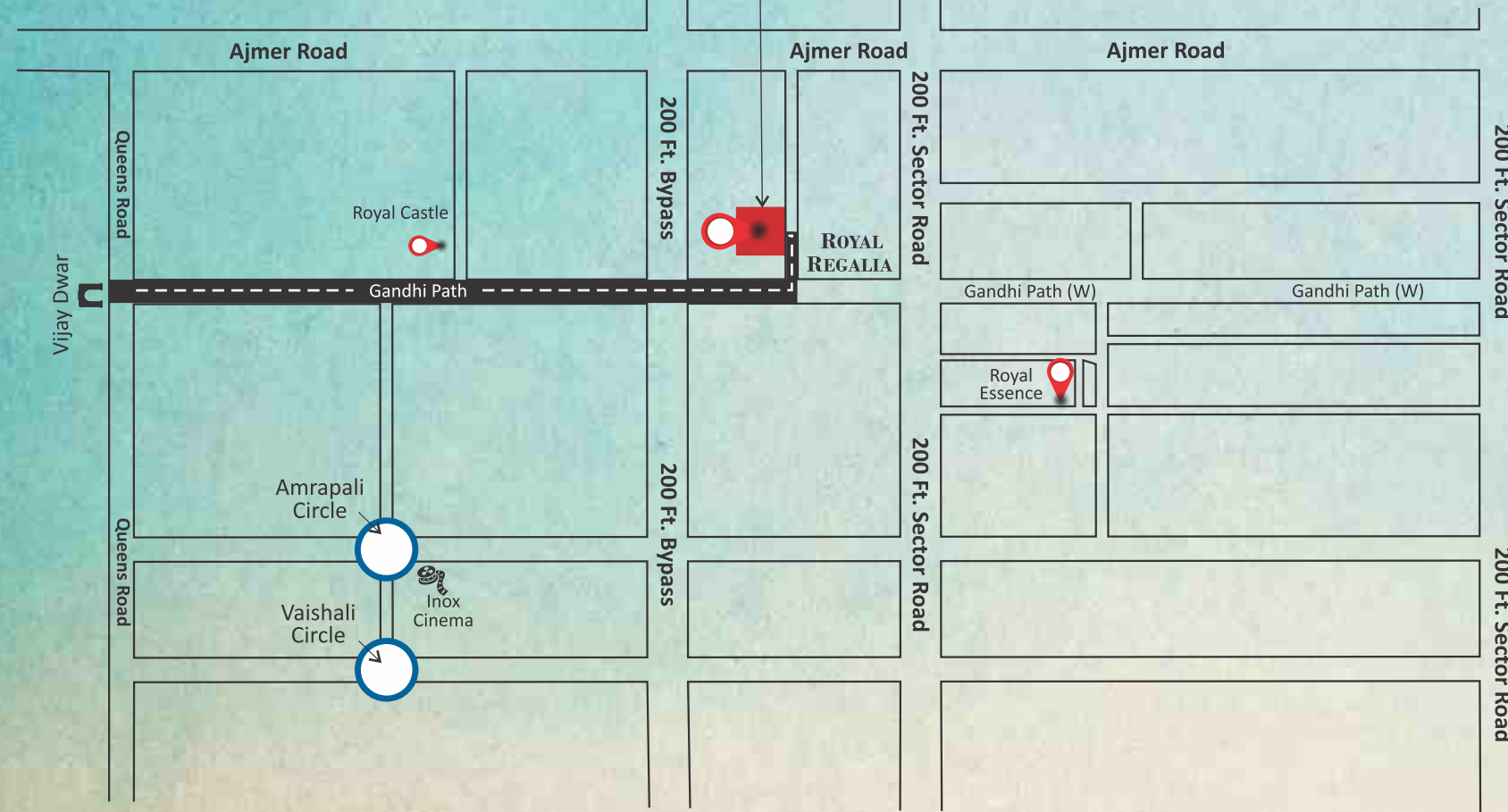

HOTELS: Hotel Sarovar Portico, Hotel Seven Seas, Hotel Marc Inn

HOSPITALS: Global Heart Hospital, Jain Fertility & Mother Care, Apollo, Vaishali Hospital, Shalby

SHOPPING / ENTERTAINMENT: Vaibhav Mall, National Handloom, Crown Plaza, Big Bazaar

BANK & ATM: HDFC Bank, ICICI Bank, Axis Bank, IDBI Bank, Bank of Baroda, SBI Bank

SCHOOL & INSTITUTE: Step by Step Sophia, Tree House, D.P.S., T.P.S.

NEIGHBORHOOD: Vaishali Nagar, Ajmer Road, Chitrakoot

TEMPLE: Jharkhand Mahadev, Akshar Dham

LANDSCAPING PLAN - STILT FLOOR



TYPICAL FLOOR PLAN

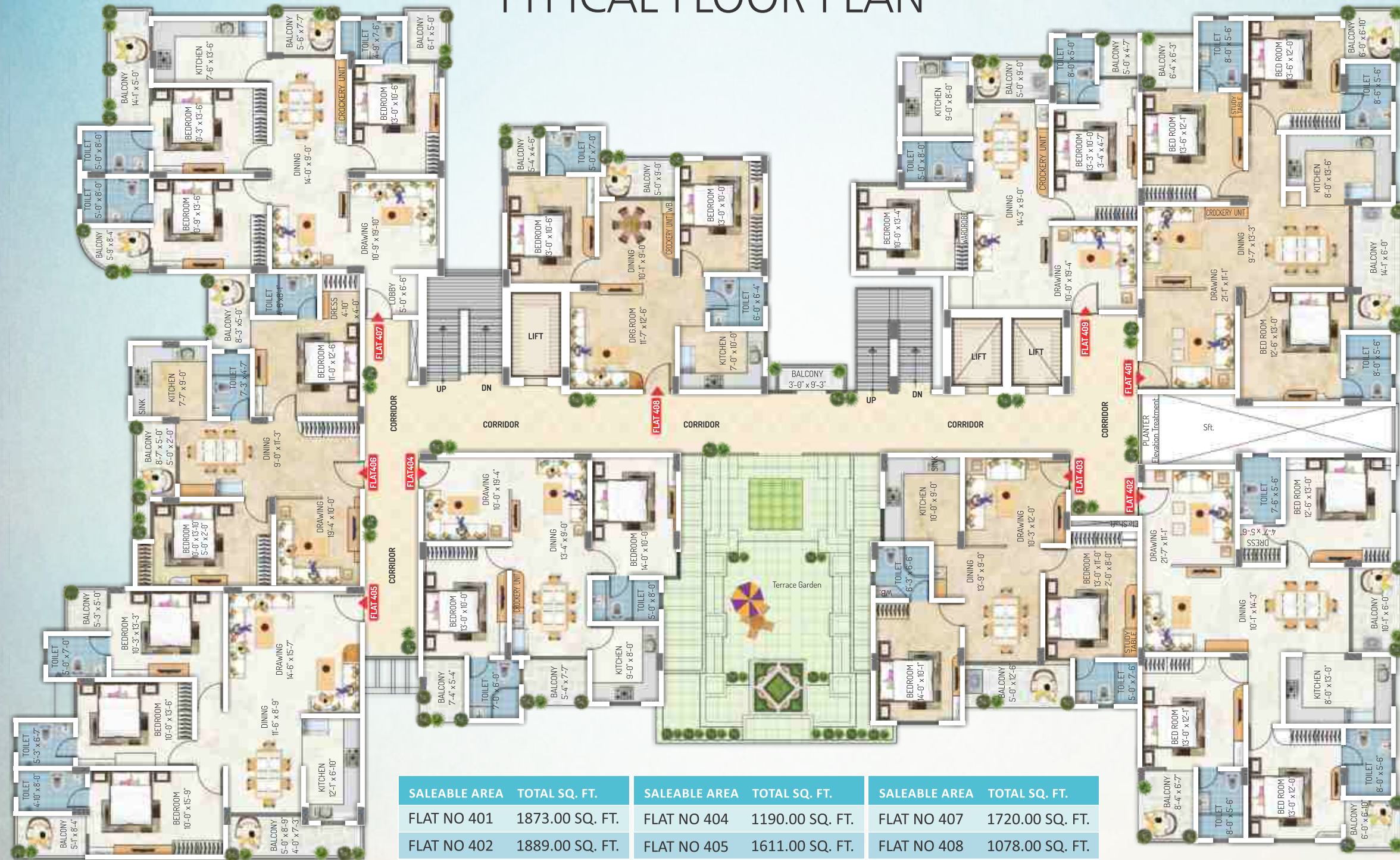

SALEABLE AREA	TOTAL SQ. FT.	SALEABLE AREA	TOTAL SQ. FT.	SALEABLE AREA	TOTAL SQ. FT.
FLAT NO 401	1873.00 SQ. FT.	FLAT NO 404	1190.00 SQ. FT.	FLAT NO 407	1720.00 SQ. FT.
FLAT NO 402	1889.00 SQ. FT.	FLAT NO 405	1611.00 SQ. FT.	FLAT NO 408	1078.00 SQ. FT.
FLAT NO 403	1163.00 SQ. FT.	FLAT NO 406	1199.00 SQ. FT.	FLAT NO 409	1213.00 SQ. FT.

Note: Built up area is less 25% of saleable area.

3 BHK

FLAT No. : **401** | SALABLE AREA: **1873.00** SQFT.



Note: Builtup area is less 25% of saleable area.

3 BHK

FLAT No. : **402** | SALABLE AREA: **1889.00** SQFT.



Artistic Impression

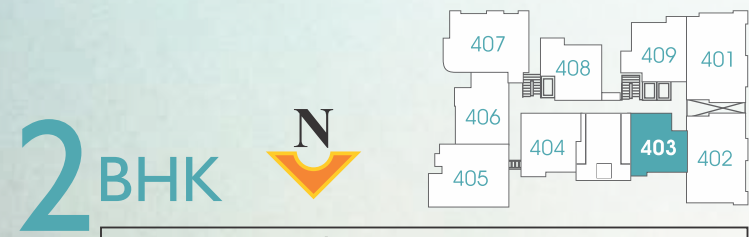

FLAT No. : **403** | SALABLE AREA: **1163.00** SQFT.

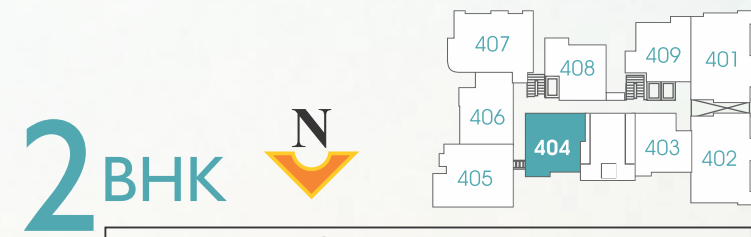

FLAT No. : **404** | SALABLE AREA: **1190.00** SQFT.

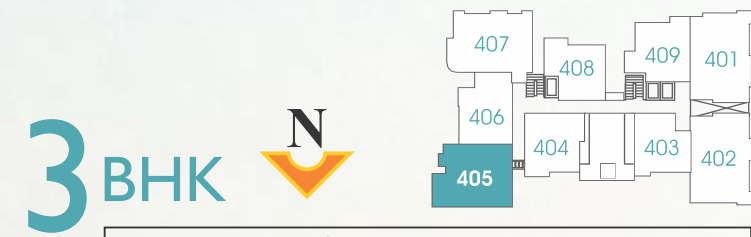

FLAT No. : **405** | SALABLE AREA: **1611.00** SQFT.

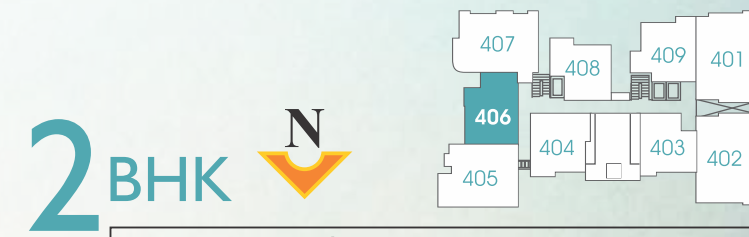

FLAT No. : **406** | SALABLE AREA: **1199.00** SQFT.

Note: Builtup area is less 25% of saleable area.

Note: Builtup area is less 25% of saleable area.

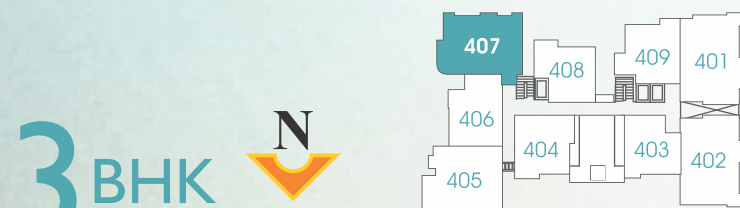

FLAT No. : **407** | SALABLE AREA: **1720.00** SQFT.

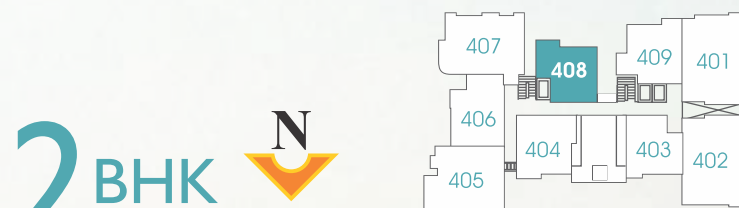

FLAT No. : **408** | SALABLE AREA: **1078.00** SQFT.

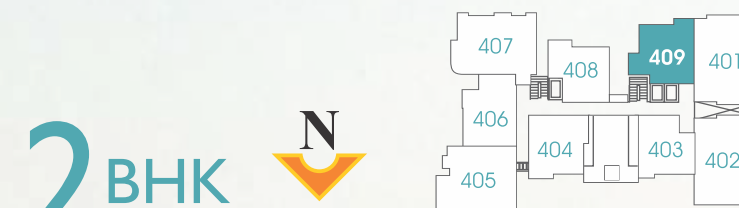

FLAT No. : **409** | SALABLE AREA: **1213.00** SQFT.

TERRACE GARDEN



Whether it's leisure time to spend, the terrace garden at Royal Regalia has a lot to offer. Take some time out and soak in the beauty of your surroundings from your balcony. Break the routine and create reasons to make life wonderful and happening.

FLAT 401

ISOMETRIC VIEW



3 BHK

SALABLE AREA: **1873.00 SQFT.**

The Vastu compliant homes here is well synced with the five elements of nature viz. Earth, Water, Fire, Air and Space that keeps a constant balance between them all and harnesses the positive energies from all. It also gives you comfort and ease, because of the fact that the proper attention is paid to every element inside your home; be it the space, air-circulation, colours, interior placements or directions.

SPECIFICATIONS

STRUCTURE

- Earthquake resistant RCC framed structure
- Appropriate fire fighting system and emergency exit through an extra staircase
- Energy efficient & eco friendly nominal design.

APARTMENT FEATURES

- Vitrified Tiles/ Marble Flooring
- False ceiling in Drawing & Dining area
- POP finish on wall & ceiling
- Premium Quality Distemper paint on wall & ceiling
- Provision for split AC in Drawing / Dining & all Bedrooms

WOOD WORK

- Aluminum/ UPVC/ Wooden Windows having glass panels.
- Premium Quality Designer Flush Doors.
- Designer fittings on doors & windows.
- Laminated Wooden flooring in Master bedroom

WATER SUPPLY

- Round the clock Water Supply by own bore well With Overhead Storage Tank
- Under Ground Water Tank For additional Water Storage
- Rain Water Harvesting System to Maintain Ground Water Level

HIGH CLASS SECURITY SYSTEM

- 24x7 Manned Security with live surveillance and recording through CCTV Cameras
- Access Control System at Main Entrance Lobby Area
- Intercom/EPBAX facility
- Video Door Phone in each flat

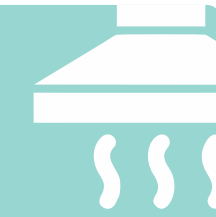

KITCHEN

- Semi Modular Kitchen
- Granite working counter
- Stainless steel sinks
- 2' Tiles dado above the counter
- Provision for geyser & R.O in kitchen

WASHROOM

- Designer Ceramic tiles in toilet up to 7' height on wall
- Premium Ceramic Tiles on Floor in toilet
- Wall hung / Floor Mounted W.C. in Toilets
- Premium Quality C.P. fittings
- Premium Quality Sanitary Ware
- Counter Wash Basin

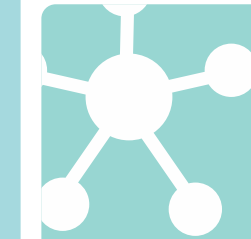

ELECTRICAL

- Fire Retardant High Quality Wires & Cables
- Premium quality Modular Switches & Accessories
- Telephone Wiring in each Room for Landline & Broadband
- Provision for inverter.

COMMON AMENITIES

- Three High Speed Automatic Elevators
- 100% Power Back-Up in Common Areas
- Well Designed Entrance Gate & Impressive Lobby Area
- HD Multi Dwelling Unit (MDU) System with a Single antenna
- Centralized Gas Bank Facility
- Driver Dormitory
- Well Club House facility with various features.

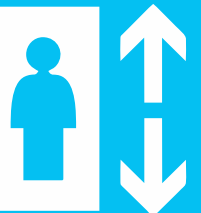
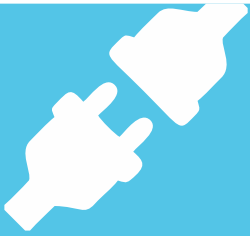



CLUB REGALIA



CLUB REGALIA

LEGENDS OF CLUB HOUSE

- Multipurpose Court
- Indoor Swimming Pool
- Society Office
- Guest Room
- Library
- Gym
- Yoga Pavilion
- Kids Play Area
- Party Area / Multi Purpose Hall
- Event Terrace
- Waiting Area

GAMING ZONE

- Pool Table
- Table Tennis Table
- Carrom
- Chess

LANDSCAPE FEATURES

- Landscaped Garden
- Interactive Seating Area
- Aromatic Plantation
- Senior Citizen Corner
- Sand Pits
- Gazebo
- Tree Court
- Paved Pathway
- Water Body
- Feature Wall
- Trellis with seating
- Terrace Garden

SPA

- Sauna
- Steam bath
- Jacuzzi
- Massage Room
- Chiller room



CREATING EXCELLENCE, INSPIRING COMMUNITIES

Gangaa Kotecha Group pushes the limits in real estate to create buildings of utmost quality. It strives to achieve the highest degree of technical excellence while maintaining the finest standards of business practices in all its endeavors. With a distinctive style of management, in just a short span of 10 years, it has been able to grab more than 16 projects. It provides efficient service to customers by combining the strength of the best team of architects, interior designers and project management consultancy that focuses on the worth of every square feet ensuring timely delivery. By highest of ethical standards and keen dedication to excellence in all aspects, it aspires to exceed customers' expectations. It is active towards environmental conservation with an uncompromising dedication. Royal Regalia is just another project where reliability and experience of the group combines with innovation and finesse to bring luxurious homes to the city dweller.

- 10 years of Excellence in Real Estate Industry
- Committed to On-Time Delivery
- Choice of wide range of Apartments
- Home Loans available from all Leading Banks
- Safe and Secure Environment in all the Projects
- High Customer Satisfaction



ONGOING						
	Royal Castle, Chitrkoot, Vaishali Nagar, Jaipur	Royal Avenue, Mansarovar Extension, Jaipur	Royal Florence, Narayan Vihar, Gopalpura, Jaipur	Royal Tatvam, Patrakar Colony, Mansarovar, Jaipur	Royal Essence, Gandhi Path (W) Vaishali Nagar, Jaipur	
	COMPLETED					
		Vardhman Apartment, Bani Park, Jaipur	Western Heights, Shyam Nagar, Jaipur	Vardhman Majesty, Shyam Nagar, Jaipur	Vardhman Residency, Ajmer Road, Jaipur	Arihant Residency, Ajmer Road, Jaipur
Arihant Enclave, Kanak Vihar, Ajmer Road, Jaipur		Arihant Palm, Ajmer Road, Jaipur	Classic Residency, Vaishali Nagar, Jaipur			
<p>— YEARS OF — EXCELLENCE ...</p>						



Corporate Office:

Ridhi Sidhi Developers

81, Gyan Vihar Colony, Near DCM,
Ajmer Road, Jaipur - 302019
Ph.: 0141- 4015550

For More Information Call Us On
+91 900 1919 111

Architect:
Space Grid

www.kotechagroup.org www.kotechagroup.in

The brochure is not a legal document. It only describes the conceptual plan to convey the intent and purpose of the developers. The specification and details mentioned in this brochure are tentative and are subject to change at the sole discretion of the developers and/or the architects.