



KAMRUP HOUSING PROJECTS PVT. LTD.
Site Office: Plot No. GH-08A, Sector CHI V, Greater Noida, Gautam Budh Nagar - 201308
Tel: +91 8010301234
e-mail: sales@kamruphousing.com
website: www.kamruphousing.com
www.durvagreens.com

ZRICKS



Garden of Boutique Homes
DURVA GREENS™

from
where
the
ZRIKKS
luxury
begins



KHP commenced its business operations in 2004 in New Delhi, and established its first project, a mini-township scheme at Guwahati, Assam, in the north-east region of India in 2005.

KHP'S sole aim is the creation of people-centric housing properties across India.

In its formative years, KHP has successfully built a well-knit management team that has the collective vision, drive & motivation, commitment and coherence to take the company through its aggressive growth plans. A process driven organization, KHP has built strong internal capabilities and systems.

Team KHP has over 75 years of collective experience in real-estate, architecture, finance and project management.

The KHP team believes in keeping people's needs at the core of its designs and planning. Its idea is to cater to contemporary lifestyles by not merely creating beautiful spaces, but by creating environments which are conducive to taking pressure off the demanding lifestyle that we lead today.



*In Indulgent Spaces where Privacy is not compromised, wallow in the feel of an Independent Home.
In these uniquely styled apartments with **Designer Class** finishes and fittings, befitting your taste for style...
... Experience a Complete Living...
in a Garden of Boutique Homes.*







MAIN ROAD

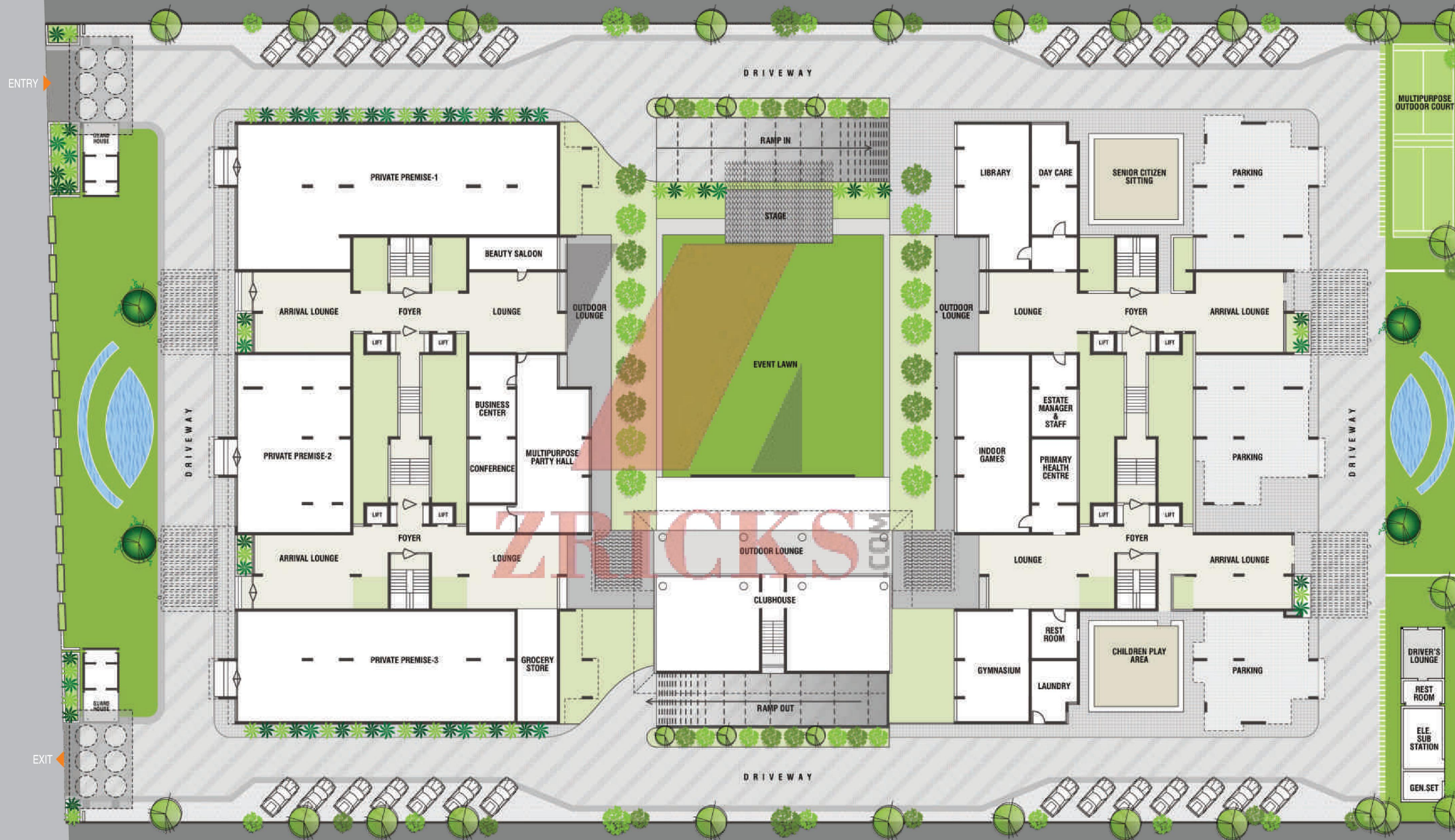



TYPICAL FLOOR



MAIN ROAD

ENTRY

EXIT

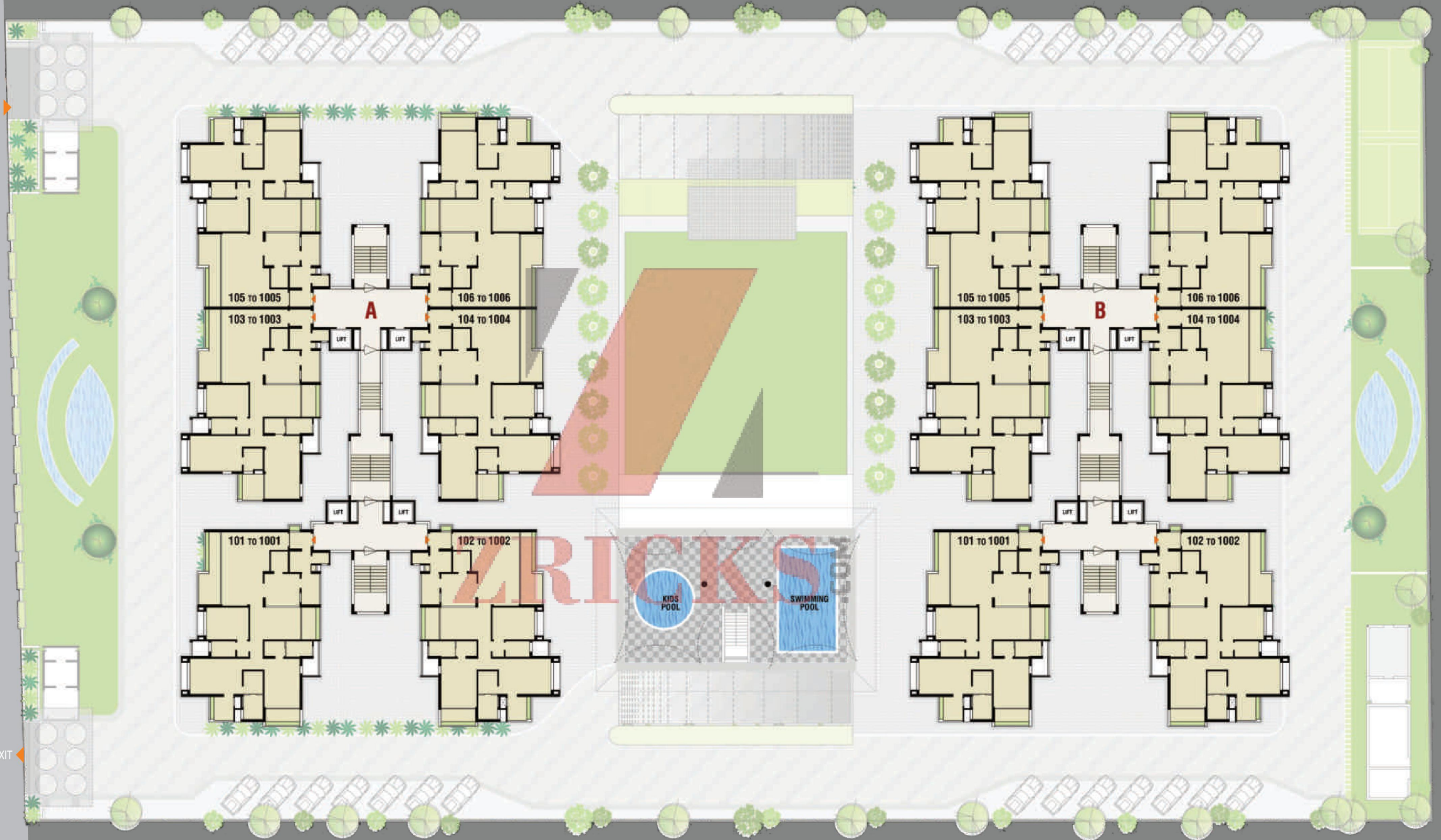

CENTRAL PARK & LANDSCAPING



UNIT PLAN TYPICAL FLOOR PLAN

Super Built-up Area : 2760 sq. ft.
 Built-up Area : 2010 sq. ft.

NO.	SPACES	AREA
1	ENTRANCE	5'-1.5" x 7'-0"
2	VESTIBULE	5'-6" x 5'-9"
3	DRAWING & LIVING	22'-4.5" x 14'-6" (AVE.)
4	BALCONY	22'-4.5" x 6'-6" & 4'-0"
5	DINNING	10'-0" x 15'-4.5"
5A	BALCONY	10'-0" x 4'-1.75"
5B	PASSAGE	9'-6" x 3'-9"
6	KITCHEN	10'-0" x 11'-0"
6A	STORE	6'-6" x 5'-4.5"
6B	UTILITY	4'-6" x 5'-7.5"
6C	WASH	5'-1.5" x 5'-7.5"
7	BEDROOM	10'-0" x 13'-0"
7A	TOILET	5'-3" x 7'-6"
7B	HAND WASH AREA	3'-9" x 5'-3"
8	MASTER BEDROOM	11'-0" x 16'-0"
8A	BALCONY	7'-9" x 6'-0"
8B	DRESS	6'-10.5" x 6'-0"
8C	TOILET	7'-9" x 6'-0"
8D	M/B VESTIBULE	4'-0.5" x 3'-7"
9	CHILDREN BEDROOM	15'-0" x 11'-0"
9A	BALCONY	3'-9" x 10'-1.5"
9B	DRESS	5'-3" x 6'-4.5"
9C	TOILET	5'-3" x 8'-1.5"
10	ATTENDANT ROOM	6'-6" x 6'-7.5"
10A	TOILET	3'-6" x 5'-1.5"





INTERIOR VIEW

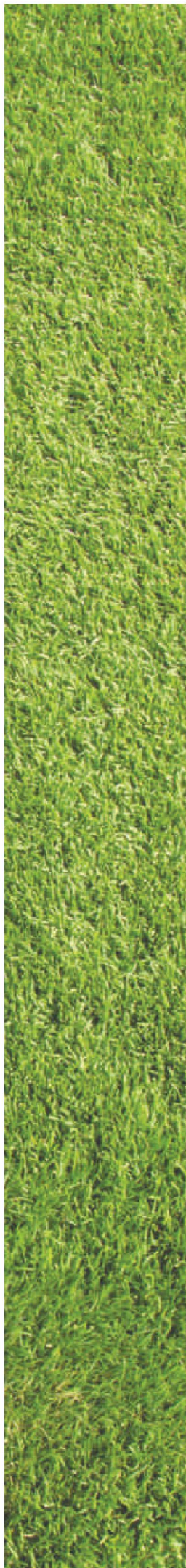

UNIT PLAN

TYPICAL FLOOR PLAN

Super Built-up Area : 2740 sq. ft.
 Built-up Area : 1997 sq. ft.



NO.	SPACES	AREA
1	ENTRANCE	5'-1.5" x 7'-0"
2	VESTIBULE	5'-6" x 5'-9"
3	DRAWING & LIVING	22'-4.5" x 14'-6" (AVE.)
4	BALCONY	22'-4.5" x 6'-6" & 4'-0"
5	DINNING	10'-0" x 15'-4.5"
5A	BALCONY	10'-0" x 4'-1.75"
5B	PASSAGE	9'-6" x 3'-9"
6	KITCHEN	10'-0" x 11'-0"
6A	STORE	6'-6" x 5'-4.5"
6B	UTILITY	4'-6" x 5'-7.5"
6C	WASH	5'-1.5" x 5'-7.5"
7	BEDROOM	10'-0" x 13'-0"
7A	TOILET	5'-3" x 7'-6"
7B	HAND WASH AREA	3'-9" x 5'-3"
8	MASTER BEDROOM	11'-0" x 16'-0"
8A	BALCONY	7'-9" x 6'-0"
8B	DRESS	6'-10.5" x 6'-0"
8C	TOILET	7'-9" x 6'-0"
8D	M/B VESTIBULE	4'-0.5" x 3'-7"
9	CHILDREN BEDROOM	15'-0" x 11'-0"
9A	BALCONY	3'-9" x 10'-1.5"
9B	DRESS	5'-3" x 6'-4.5"
9C	TOILET	5'-3" x 8'-1.5"
10	ATTENDANT ROOM	6'-6" x 6'-7.5"
10A	TOILET	3'-6" x 5'-1.5"





UNIT PLAN

TYPICAL FLOOR PLAN

Super Built-up Area : 2670 sq. ft.
 Built-up Area : 1952 sq. ft.

NO.	SPACES	AREA
1	ENTRANCE	5'-1.5" x 7'-0"
2	VESTIBULE	5'-6" x 5'-9"
3	DRAWING & LIVING	22'-4.5" x 14'-6" (AVE.)
4	BALCONY	22'-4.5" x 6'-6" & 4'-0"
5	DINNING	10'-0" x 15'-4.5"
5A	BALCONY	10'-0" x 4'-1.75"
5B	PASSAGE	9'-6" x 3'-9"
6	KITCHEN	10'-0" x 11'-0"
6A	STORE	6'-6" x 5'-4.5"
6B	UTILITY	4'-6" x 5'-7.5"
6C	WASH	5'-1.5" x 5'-7.5"
7	BEDROOM	10'-0" x 13'-0"
7A	TOILET	5'-3" x 7'-6"
7B	HAND WASH AREA	3'-9" x 5'-3"
8	CHILDREN BEDROOM	11'-0" x 16'-0"
8A	TOILET	7'-6" x 6'-0"
8B	C/B VESTIBULE	4'-0.5" x 3'-7"
9	MASTER BEDROOM	19'-6" x 11'-0"
9A	BALCONY	8'-6" x 6'-5"
9B	DRESS	5'-3" x 6'-4.5"
9C	TOILET	5'-3" x 8'-1.5"
10	ATTENDANT ROOM	6'-6" x 6'-7.5"
10A	TOILET	3'-6" x 5'-1.5"

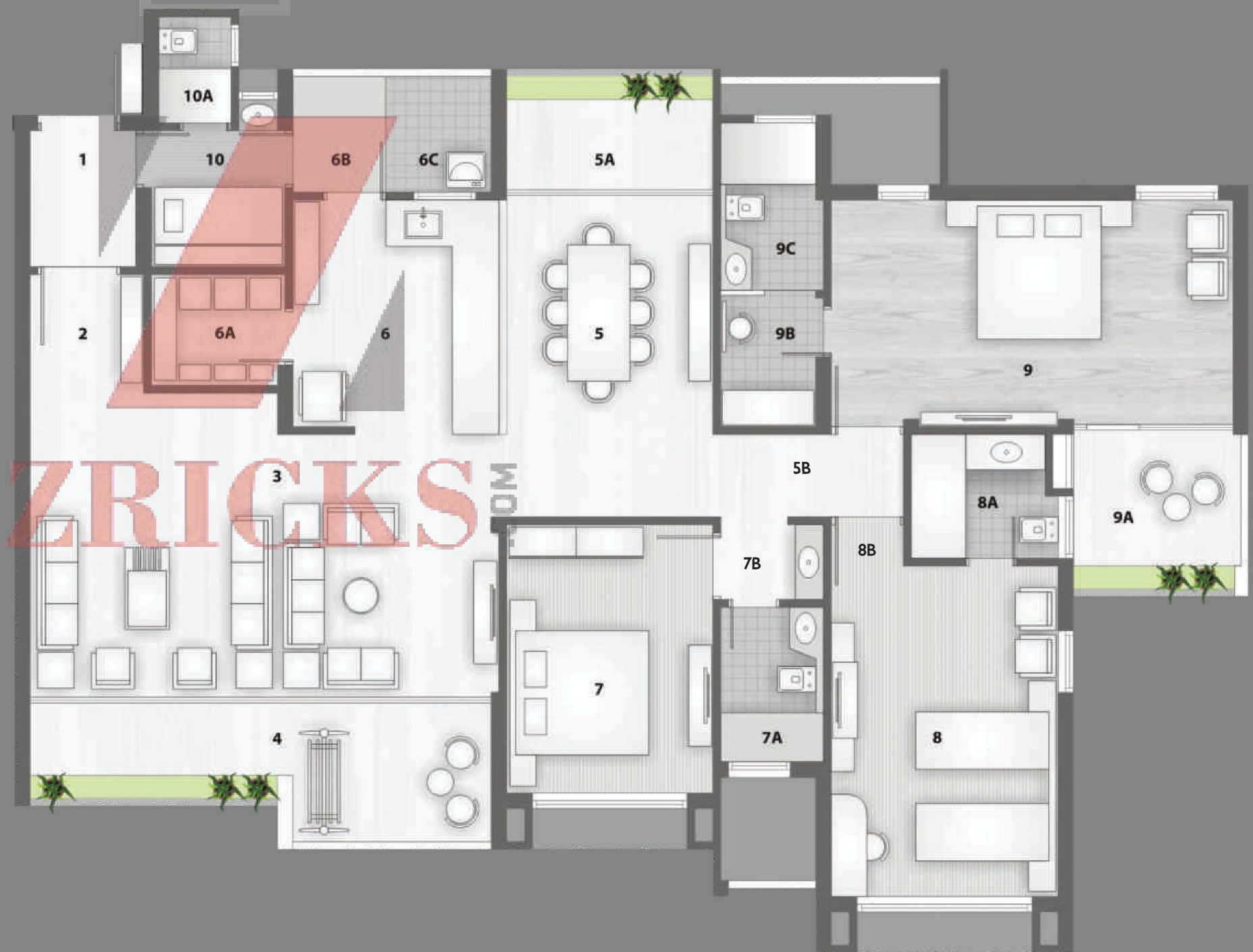

SALIENT FEATURES

- Club house with all modern facilities
- Swimming pool and kids splash pool
- Changing Rooms
- Multipurpose Party hall
- Beauty saloon
- Rest Room for common use
- Laundry
- Grocery store
- Library
- Estate Manager & Maintenance Staff
- Gymnasium
- Daycare Center
- Primary Health Center
- Entrance Lobby / Arrival Lounge
- Outdoor Lounge facing central open space
- Foyers at Ground floor
- Electric Sub station
- 100 % power back-up with Generator Room
- Driver's Lounge & Rest room
- Bore well
- Senior Citizen Area
- Children Play Area
- Multipurpose Outdoor Central Court
- International class soft & hard landscaping in open areas with Water bodies & Fountains
- Under Ground Water Tanks
- Fire Fighting System as per norms
- Lifts of reputed Brand
- Adequate Parking Facilities
- Round O'clock Professional Security



Garden of Boutique Homes
DURVA GREENS™



ULTRA MODERN SPECIFICATION

STRUCTURE		: Earthquake resistant RCC frame structure
VESTIBULE LIVING ROOM & DINING	Floor	: Composite marble
	Walls	: Acrylic Emulsion paint on POP punning with One wall in textured finish in living room
	Ceiling	: Acrylic Emulsion paint and POP false ceiling
BEDROOMS	Floor	: Top-end wooden flooring
	Walls	: Acrylic Emulsion paint on POP punning
	Ceiling	: Acrylic Emulsion paint and POP false ceiling
	Closet	: Designer range closets with premium fittings
BATHROOMS	Walls	: Spanish / Italian designer range ceramic tiles upto lintel level
	Floor	: Spanish / Italian designer range anti-skid ceramic tiles
	Counters	: Marble or granite
	Fittings/Fixtures	: Top-end imported designer range CP fittings, wall hung EWC, washbasin and fittings, Glass partition, Shower panel in master bathroom
	Geysers	: Top-end Storage geysers
KITCHEN	Fit-outs	: Designer range modular kitchen with imported soft close cabinets and doors; corian counter built in microwave, top-end built in oven, hob and electric chimney; high grade SS Sink
	Walls	: Acrylic emulsion paint
	Floor	: Composite marble
	Fittings/Fixtures	: CP fittings, High quality branded stainless steel sink with drain board, exhaust fan
	Plumbing	: CPVC Schedule 80 - Aqua gold for water supply, Kitee supreme grade SWR for drainage
	Geysers	: Top-end Storage geysers
	Doors	: Melamine Polished hardwood frame
DOORS	Doors	: 1. Main door: teak wood panel door with melamine finish with magic eye; 2. All Doors: Teak wood panel door with melamine finish
	Hardware	: Top-end Shutter hinges and all other hardware in SS, All doors with mortice lock except those in kitchen and bathrooms
	Balcony	: UPVC coated wooden finish full length with toughened glass shutters
WINDOWS	Bedrooms, Bathrooms & Kitchen	: UPVC coated wooden finish with toughened glass shutters
	BALCONY	Floor : Top-end Combination of one or more rustic textured finish tiles Railing : Glass and SS Ceiling : Acrylic Emulsion paint
ELECTRIC FITTINGS	Lights	: Top-end designer range light fittings on walls with bulbs / CFL
	Switches	: Top-end designer range of modular plates and switches
AIR-CONDITIONERS	Ducting	: Provided Hitachi or equivalent in living, dining, bedrooms
ELECTRIC WORKS		: Electrical works with ISS copper wire in concealed PVC conduits, provisions for sufficient power points, light points, switches & sockets; Telephone and TV points in living, bedrooms
SECURITY SYSTEMS		: Video door phone, EPBAX connectivity with Complex gate and security
DRINKING WATER SUPPLY		: Through individual RO plants
GAS SUPPLY		: Provision for piped gas
CONNECTIVITY	Internet	: Broad-band connection as available in the area
	Telephone	: Common box at Ground level, internal wiring for connection as available in the area
	DTH / Cable	: Internal wiring for DTH / Cable connectivity in living and bedrooms
GARBAGE		: Garbage Chute
EXTERNAL FINISHES		: Sand face plaster with water resistant acrylic outdoor paint
ATTENDANTS ROOM	Floor	: Standard Vitrified tiles
	Walls	: Acrylic emulsion paint
	Ceiling	: Acrylic emulsion paint
	Bathroom	: Standard Vitrified tiles with Standard CP fittings

Disclaimer :

"All specifications, artistic renderings and images in this brochure are purely conceptual/indicative and are not a legal offering. They can be changed at the sole discretion of the company or by any competent authority in the best interest of the development."



RECOGNITION

DURVA GREENS™

Plot No. GH-08A, Sector Chi V, Gautam Buddha Nagar, Greater Noida, Uttar Pradesh.

