

3BP
ENERGY

ZRICKS

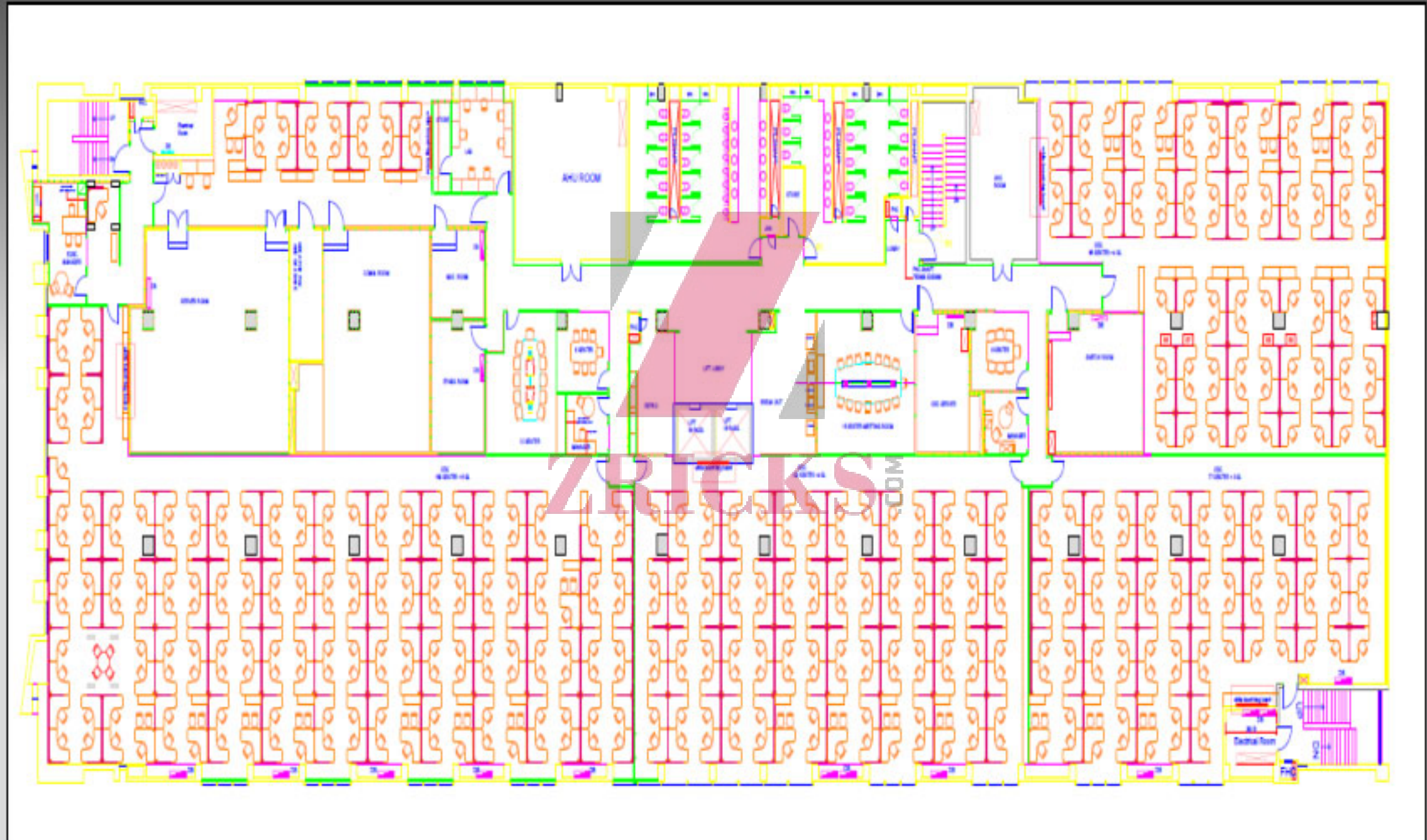

ASF Synergy : Floor Plan



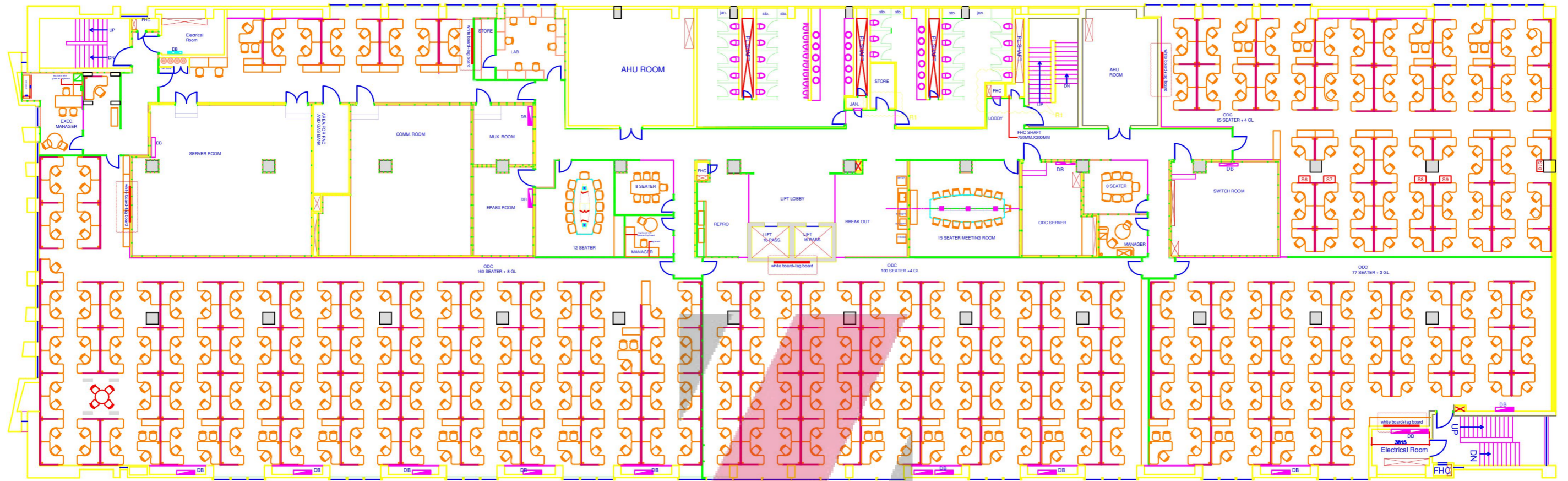

DOOR SCHEDULE

S.N.	TYPE	LOCATION	CLEAR MASONRY		FRAME TYPE	HARDWARE SCHEDULE (FOR ONE NOS. OF DOOR TYPE)								
			SIZE	LINTEL		FULL HANDLE (FMS)	PAIR OF HINGES	DOOR CLOSER	DOOR STOPPER	BULL HORN	LOCK	REMARK		
1	D1	MAIN ENTRANCE - GROUND FLOOR	1500x2350	+2350 MM.	FRAMELESS GLASS DOOR									
2	D2	BOARD ROOM	1500x2350	+2350 MM.	FLUSH DOOR (BOTH SIDES VENEER) WITH VISION PANEL									
3	D3	EXEC. DINING	900x2350	+2350 MM.	FRAMELESS GLASS DOOR									
4	D4	MANAGER'S SEATER MEETING	900x2350	+2350 MM.	FLUSH DOOR (BOTH SIDE LAMINATE)									
5	D4A	12 SEATER MEETING RM.	900x2350	+2350 MM.	FLUSH DOOR (BOTH SIDE LAMINATE) WITH VISION PANEL									
6	D5	ODC SERVER ROOM / SWITCH ROOM	1200x2350	+2350 MM.	ACCESS CONTROL FLUSH DOOR (BOTH SIDES LAMINATE)									
7	D6	ODC ENTRANCE DOOR	1000x2350	+2350 MM.	ACCESS CONTROL FLUSH DOOR (BOTH SIDES LAMINATE)									
8	D7	GROUND FLOOR CORRIDOR ENTRANCE	1000x2350	+2350 MM.	FLUSH DOOR (BOTH SIDE LAMINATE) WITH VISION PANEL									
9	D8	AHU/UPS DOOR	1500x2350	+2350 MM.	WOODEN FIRE DOOR (BOTH SIDES LAMINATE)									
10	D9	STORAGE DOOR	1200x2350	+2350 MM.	WOODEN FIRE DOOR WITH VISION PANEL (BOTH SIDES LAMINATE)									
11	D10	TOILET MAIN ENTRY	1000x2350	+2350 MM.	FLUSH DOOR (BOTH SIDE LAMINATE) WITH 200MM HIGH LOUVERS AT THE BOTTOM									
12	D11	HANDWASH TOILET	1000x2350	+2350 MM.	FLUSH DOOR (BOTH SIDE LAMINATE) WITH 200MM HIGH LOUVERS AT THE BOTTOM									
13	D12	EXEC. TOILET	900x2350	+2350 MM.	FLUSH DOOR (BOTH SIDE LAMINATE) WITH 200MM HIGH LOUVERS AT THE BOTTOM									

14	D13	FHC DOOR	750x2350	+2350 MM.	FLUSH DOOR (BOTH SIDE LAMINATE)									
15	D14	KITCHEN	1200x2350	+2350 MM.	FLUSH WITH VISION PANEL (BOTH SIDES LAMINATE)									
16	D15	KITCHEN ENTRANCE DOOR FROM OUTSIDE	1200x2350	+2350 MM.	FLUSH DOOR (BOTH SIDE LAMINATE)									
17	D16	ELECTRICAL RM.	1200x2350	+2350 MM.	WOODEN FIRE DOOR (BOTH SIDES LAMINATE)									
18	D17	JANITOR	600x2350	+2350 MM.	FLUSH DOOR (BOTH SIDE LAMINATE)									
19	D18	SHWFT DOOR	600x2350	+2350 MM.	FLUSH DOOR (BOTH SIDE LAMINATE)									
20	D19	SERVER ROOM	1500x2350	+2350 MM.	WOODEN FIRE DOOR (BOTH SIDES LAMINATE)									
21	D20	LIFT LOBBY ENTRANCE	1200x2350	+2350 MM.	FRAMELESS GLASS DOOR (ACCESS CONTROLLED)									
22	D21	EXECUTIVE CABIN	1000x2350	+2350 MM.	FLUSH DOOR (ONE SIDE VENEER ONE SIDE LAMINATE)									
23	D22	15 SEATER MEETING ROOM	1000x2350	+2350 MM.	FLUSH DOOR (ONE SIDE VENEER ONE SIDE LAMINATE) WITH VISION PANEL									
24	D23	MAIN LT PANEL ENCLOSURE	2400x2350	+2350 MM.	WOODEN FIRE DOOR (BOTH SIDES LAMINATE)									
25	D24	ENGR. OFFICE	1000x2350	+2350 MM.	FRAMED GLASS DOOR									

NOTE.
ALL MASONRY WORKS IN 100MM. OR 200MM. THK. BLOCKWORK AS SHOWN R2

PROJECT
**ASF FACILITY AT 154 B,
BLOCK A ,SECTOR 63 ,NOIDA**

DRAWING TITLE
**FIRST FLOOR
DIMENSION PLAN**



REVISIONS

NO.	DATE	DESCRIPTION
R1	26.09.07	REV MARKED AS R1
R2	1.11.07	REV MARKED AS R2

DATE	20-08-07
SCALE	1 : 125
DRAWN	dks
PRJ. ARCHT.	Brinda Virmani
FILE NAME	

WORKING DRAWING

**S-296
GREATER KAILASH II
NEW DELHI 110 048**
SPAZZIO
DESIGN
ARCHITECTURE
PVT. LTD. Tel. : 29217646, 292111879
Fax : 91-011-29216835

DRG. NO.
ID-203
PROJ. NO.
0507

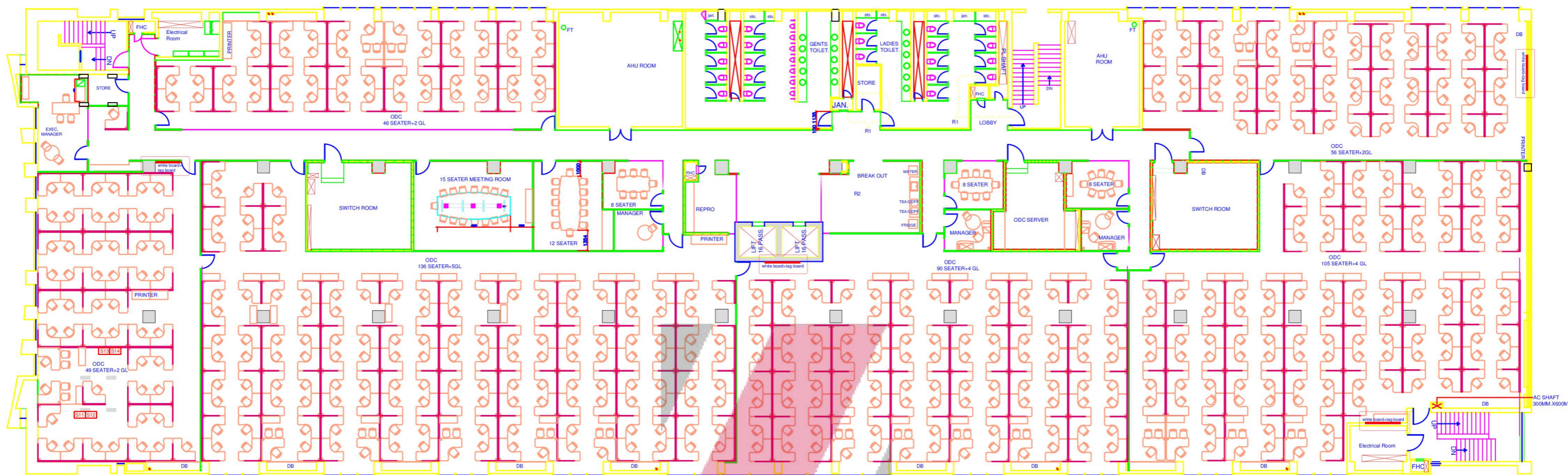

DOOR SCHEDULE

S.N.	TYPE	LOCATION	CLEAR MASONRY		FRAME TYPE	HARDWARE SCHEDULE (FOR ONE NOS. OF DOOR TYPE)					REMARK	
			SIZE	LINTEL		PULL HANDLE (MM)	PAIR OF DOOR HINGES	DOOR CLOSER	DOOR STOPPER	WALL GUARD		LOCK
1	D1	MAIN ENTRANCE - GROUND FLOOR	1500X2350	+2350 MM.	FRAMELESS GLASS DOOR							
2	D2	BOARD ROOM	1500X2350	+2350 MM.	FLUSH DOOR (BOTH SIDES VENEER) WITH VISION PANEL							
3	D3	EXEC. DINING	800X2350	+2350 MM.	FRAMELESS GLASS DOOR							
4	D4	MANAGER'S SEATER MEETING	800X2350	+2350 MM.	FLUSH DOOR (BOTH SIDE LAMINATE)							
5	D4A	12 SEATER MEETING RM.	800X2350	+2350 MM.	FLUSH DOOR (BOTH SIDE LAMINATE) WITH VISION PANEL							
6	D5	ODC SERVER ROOM / SWITCH ROOM	1200X2350	+2350 MM.	ACCESS CONTROL FLUSH DOOR (BOTH SIDES LAMINATE)							
7	D6	ODC ENTRANCE DOOR	1000X2350	+2350 MM.	ACCESS CONTROL FLUSH DOOR (BOTH SIDES LAMINATE)							
8	D7	GROUND FLOOR CORRIDOR ENTRANCE	1000X2350	+2350 MM.	FLUSH DOOR (BOTH SIDE LAMINATE) WITH VISION PANEL							
9	D8	AHU/UPS DOOR	1500X2350	+2350 MM.	WOODEN FIRE DOOR (BOTH SIDES LAMINATE)							
10	D9	STAIRCASE DOOR	1200X2350	+2350 MM.	WOODEN FIRE DOOR WITH VISION PANEL (BOTH SIDES LAMINATE)							
11	D10	TOILET MAIN ENTRY	1000X2350	+2350 MM.	FLUSH DOOR (BOTH SIDE LAMINATE) WITH 200MM HIGH LOUVERS AT THE BOTTOM							
12	D11	HANDICAP TOILET	1050X2350	+2350 MM.	FLUSH DOOR (BOTH SIDE LAMINATE) WITH 200MM HIGH LOUVERS AT THE BOTTOM							
13	D12	EXEC. TOILET	800X2350	+2350 MM.	FLUSH DOOR (BOTH SIDE LAMINATE) WITH 200MM HIGH LOUVERS AT THE BOTTOM							

13	D12	EXEC. TOILET	800X2350	+2350 MM.	FLUSH DOOR (BOTH SIDE LAMINATE) WITH 200MM HIGH LOUVERS AT THE BOTTOM							
14	D13	FHC DOOR	750X2350	+2350 MM.	FLUSH DOOR (BOTH SIDE LAMINATE)							
15	D14	KITCHEN	1200X2350	+2350 MM.	FLUSH WITH VISION PANEL (BOTH SIDES LAMINATE)							
16	D15	KITCHEN ENTRANCE DOOR FROM OUTSIDE	1200X2350	+2350 MM.	FLUSH DOOR (BOTH SIDE LAMINATE)							
17	D16	ELECTRICAL RM.	1200X2350	+2350 MM.	WOODEN FIRE DOOR (BOTH SIDES LAMINATE)							
18	D17	JANITOR	800X2350	+2350 MM.	FLUSH DOOR (BOTH SIDE LAMINATE) WITH 200MM HIGH LOUVERS AT THE BOTTOM							
19	D18	SHAFT DOOR	800X2350	+2350 MM.	FLUSH DOOR (BOTH SIDE LAMINATE)							
20	D19	SERVER ROOM	1500X2350	+2350 MM.	WOODEN FIRE DOOR (BOTH SIDES LAMINATE)							
21	D20	LIFT LOBBY ENTRANCE	1200X2350	+2350 MM.	FRAMELESS GLASS DOOR (ACCESS CONTROLLED)							
22	D21	EXECUTIVE CHAIR	1000X2350	+2350 MM.	FLUSH DOOR (ONE SIDE VENEER ONE SIDE LAMINATE)							
23	D22	15 SEATER MEETING ROOM	1000X2350	+2350 MM.	FLUSH DOOR (ONE SIDE VENEER ONE SIDE LAMINATE) WITH VISION PANEL							
24	D23	MAIN LT PANEL INSETMENT	2400X2350	+2350 MM.	WOODEN FIRE DOOR (BOTH SIDES LAMINATE)							
25	D24	ENCL. OFFICE	1000X2350	+2350 MM.	FRAMED GLASS DOOR							
26	D25	STORE ROOM	800X2350	+2350 MM.	FLUSH DOOR (BOTH SIDE LAMINATE)							
27	D26	SHAFT DOORS	800X2350	+2350 MM.	FLUSH DOOR (BOTH SIDE LAMINATE) WITH 200MM HIGH LOUVERS AT THE BOTTOM							

NOTE:
ALL MASONRY WORKS IN 100MM.
OR 200MM. THK. BLOCKWORK AS SHOWN

PROJECT
**ASF FACILITY AT 154 B,
BLOCK A ,SECTOR 63 ,NOIDA**

DRAWING TITLE
**SECOND FLOOR DIMENSION
PLAN**



AS BUILT DRAWING
CONTRACTOR:
RAJ INTER DECOR (P)LTD.
18, MATHURA ROAD, FARIDABAD.
PHONE NO. -0129-4191919

DATE 20-08-07
SCALE 1 : 125
DRAWN dks
PRJ. ARCHT. Brinda Virmani
FILE NAME

WORKING DRAWING
S-296
GREATER KAILASH II
NEW DELHI 110 048
SPAZZIO
DESIGN
ARCHITECTURE
PVT. LTD.
Tel. : 29217646, 292111879
Fax : 91-011-29216835

DRG. NO.
ID-204
PROJ. NO.
0507

R2

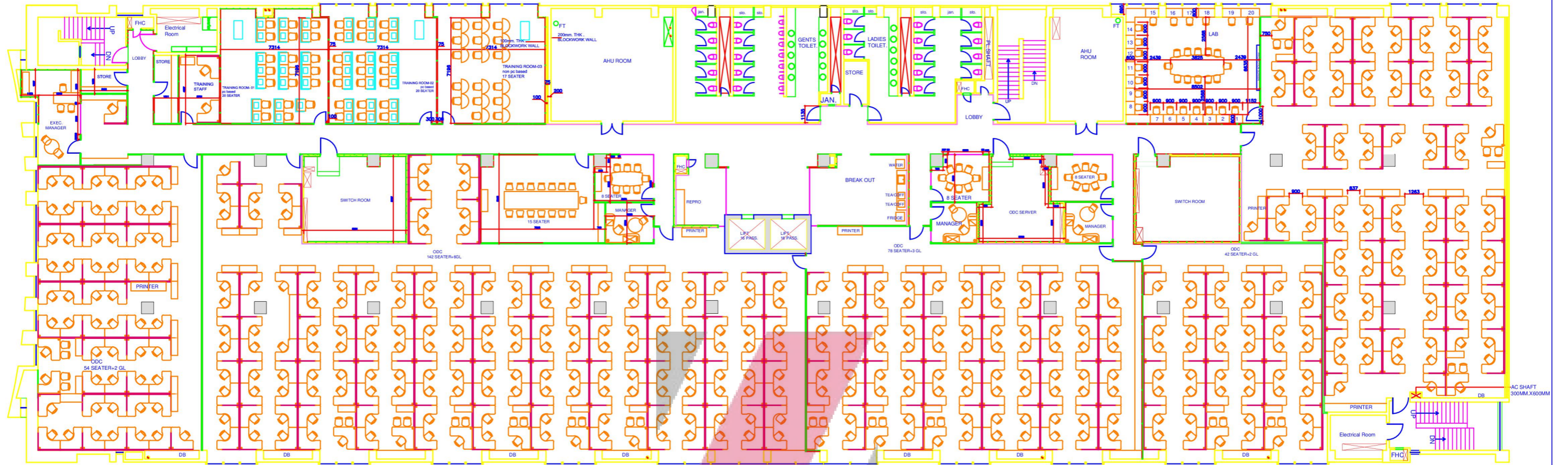

DOOR SCHEDULE

S.N.	TYPE	LOCATION	CLEAR MASONRY		FRAME TYPE	HARDWARE SCHEDULE (FOR ONE NOS. OF DOOR TYPE)					
			SIZE	LINTEL		FULL HANDLE (PWS)	PAIR OF DOOR HANDS	GLASS DOOR/POPPER	BELL HANDS	LOCK	REMARK
1	D1	MAIN ENTRANCE -GROUND FLOOR	1500x2350	+2350 M/L	FRAMELESS GLASS DOOR						
2	D2	BOARD ROOM	1500x2350	+2350 M/L	FLUSH DOOR (BOTH SIDES VENEER) WITH VISION PANEL						
3	D3	EXEC. DINING	900x2350	+2350 M/L	FRAMELESS GLASS DOOR						
4	D4	MANAGER'S SEATER MEETING	900x2350	+2350 M/L	FLUSH DOOR (BOTH SIDE LAMINATE)						
5	D4A	12 SEATER MEETING RM.	900x2350	+2350 M/L	FLUSH DOOR (BOTH SIDE LAMINATE) WITH VISION PANEL						
6	D5	ODC SERVER ROOM / SWITCH ROOM	1200x2350	+2350 M/L	ACCESS CONTROL FLUSH DOOR (BOTH SIDES LAMINATE)						
7	D6	ODC ENTRANCE DOOR	1000x2350	+2350 M/L	ACCESS CONTROL FLUSH DOOR (BOTH SIDES LAMINATE)						
8	D7	GROUND FLOOR CORRIDOR ENTRANCE	1000x2350	+2350 M/L	FLUSH DOOR (BOTH SIDE LAMINATE) WITH VISION PANEL						
9	D8	AHU/UPS DOOR	1500x2350	+2350 M/L	WOODEN FIRE DOOR(BOTH SIDES LAMINATE)						
10	D8	SERVICE DOOR	1200x2350	+2350 M/L	WOODEN FIRE DOOR WITH VISION PANEL (BOTH SIDES LAMINATE)						
11	D10	TOILET MAIN ENTRY	1000x2350	+2350 M/L	FLUSH DOOR (BOTH SIDE LAMINATE) WITH 200MM HIGH LOUVERS AT THE BOTTOM						
12	D11	WINDOOP TOILET	1000x2350	+2350 M/L	FLUSH DOOR (BOTH SIDE LAMINATE) WITH 200MM HIGH LOUVERS AT THE BOTTOM						
13	D12	EXEC. TOILET	900x2350	+2350 M/L	FLUSH DOOR (BOTH SIDE LAMINATE) WITH 200MM HIGH LOUVERS AT THE BOTTOM						
14	D13	FIN DOOR	750x2350	+2350 M/L	FLUSH DOOR (BOTH SIDE LAMINATE) WITH VISION PANEL AT +2350 M/L LEVEL						

15	D14	KITCHEN	1200x2350	+2350 M/L	FLUSH WITH VISION PANEL (BOTH SIDES LAMINATE)						
16	D15	KITCHEN ENTRANCE DOOR FROM OUTSIDE	1200x2350	+2350 M/L	FLUSH DOOR (BOTH SIDE LAMINATE)						
17	D16	ELECTRICAL RM.	1200x2350	+2350 M/L	WOODEN FIRE DOOR(BOTH SIDES LAMINATE)						
18	D17	JANITOR	600x2350	+2350 M/L	FLUSH DOOR (BOTH SIDE LAMINATE)						
19	D18	SHWY DOOR	600x2350	+2350 M/L	FLUSH DOOR (BOTH SIDE LAMINATE)						
20	D19	SERVER ROOM	1500x2350	+2350 M/L	WOODEN FIRE DOOR(BOTH SIDES LAMINATE)						
21	D20	LIFT LOBBY ENTRANCE	1200x2350	+2350 M/L	FRAMELESS GLASS DOOR(ACCESS CONTROLLED)						
22	D21	EXECUTIVE CABIN	1000x2350	+2350 M/L	FLUSH DOOR(ONE SIDE VENEER ONE SIDE LAMINATE)						
22	D22	20 SEATER MEETING RM.	1000x2350	+2350 M/L	FLUSH DOOR(ONE SIDE VENEER ONE SIDE LAMINATE) WITH VISION PANEL						
23	D23	MAIN LT PANEL BUREAU	2400x2350	+2350 M/L	WOODEN FIRE DOOR(BOTH SIDES LAMINATE)						
24	D24	ENGL. OFFICE	1000x2350	+2350 M/L	FRAMELESS GLASS DOOR						
25	D25	STORE ROOM	900x2350	+2350 M/L	FLUSH DOOR (BOTH SIDE LAMINATE)						
26	D26	SHWY DOOR	600x2350	+2350 M/L	FLUSH DOOR (BOTH SIDE LAMINATE) WITH VISION PANEL AT +2350 M/L LEVEL						

PROJECT
**ASF FACILITY AT 154 B,
 BLOCK A ,SECTOR 63 ,NOIDA**

DRAWING TITLE
**THIRD FLOOR
 DIMENSION PLAN**



REVISIONS

NO.	DATE	DESCRIPTION

DATE	21-08-07
SCALE	1 : 125
DRAWN	dks
PRJ. ARCHT.	Brinda Virmani
FILE NAME	

WORKING DRAWING

S-296
**GREATER KAILASH II
 NEW DELHI 110 048**
 SP4ZZ10
 DESIGN ARCHITECTURE PVT. LTD.
 Tel. : 29217646, 292111879
 Fax : 91-011-29216835

DRG. NO.
ID-205
 PROJ. NO.
0507

Project Location

The Property is conveniently connected to Delhi & Ghaziabad via NH-24

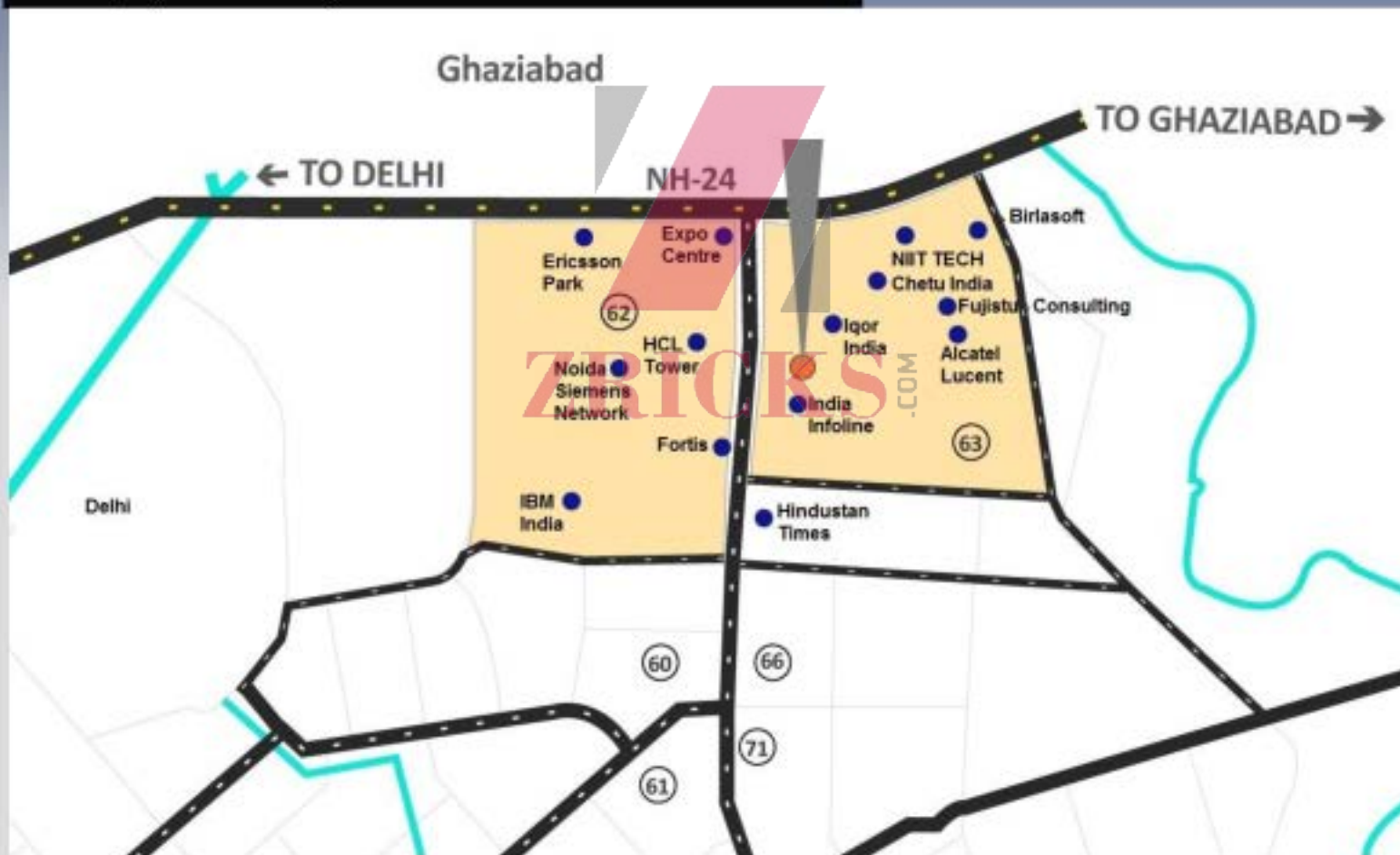

ASF Synergy : Project Details



General	
Location	ASF Synergy, A-154 B, Sector 63, Noida
Land Use & Zoning	IT / ITES

Space Details	
Plot Area	1.53 acres
Total Super Area	175,000 sq.. ft.. (approx.)
Total floors in the building	1 Basement + Ground + 4 Floors
Average Floor Plate	Approx. 42,000 sq. ft. (G+3) Approx. 7,000 sq. ft. (4 th)
Efficiency	80% (\pm 2% for uptake of entire building)
Floor to Ceiling Height	8 ft.

Technical Specifications	
Electrical Load	2000 + KVA
Power provided per sq. ft.	5 watts (low side)
Power Back up	100% back up power in N+1 configuration
Lifts	2 Passenger Lifts
Workstation Size	5 ft.. x 5 ft..
Number of Ports / per workstation	1 point for Voice & 2 points for Data
Car Parks	100 cars + 280 bikes (Covered) 15 cars + 120 bikes (Periphery)

Disclaimer: The information mentioned in this document are liable to change. The commercial terms mentioned here are indicative and do not constitute a general or legally binding offer.



ASF
SYNERGY

ZRICKS .COM



ZRICKS .COM

