



UPPALS

ZRICKS.COM



ZRICKS.COM





ZRICKS



ZRICKS
COM



ZRICKS.COM

UPPAL'S BUSINESS CENTRE

UPPER BASEMENT FLOOR PLAN

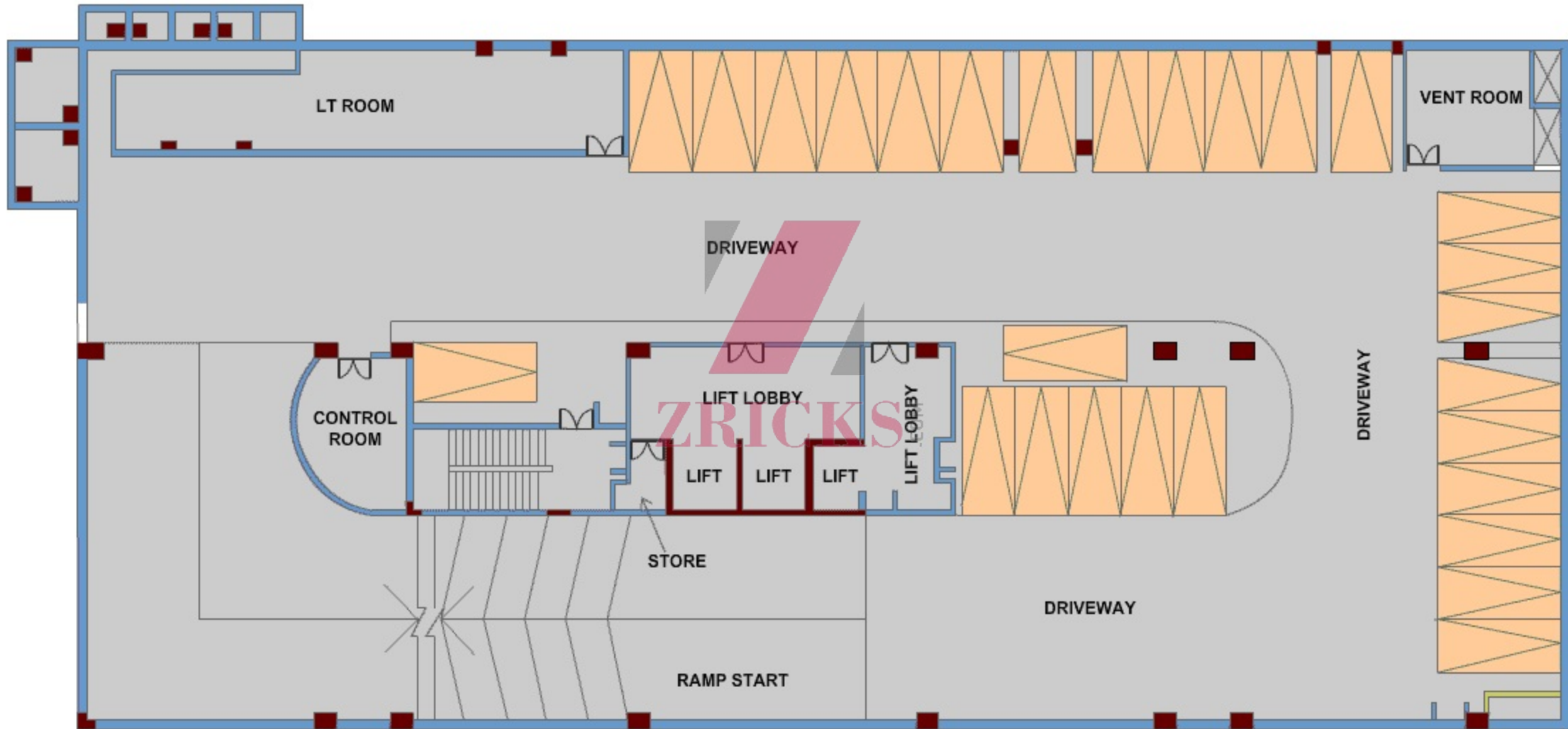

GROUND FLOOR PLAN

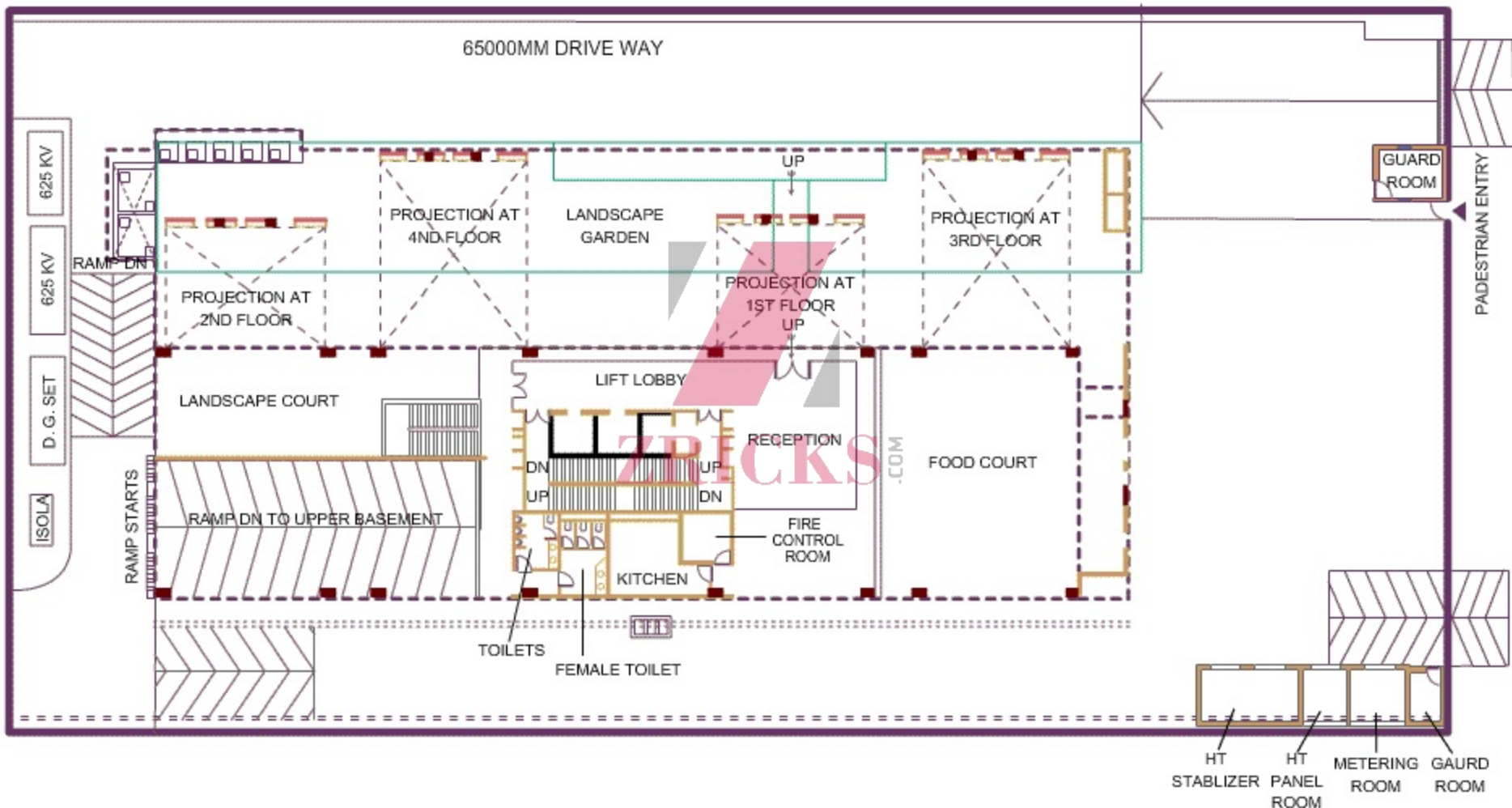

UPPER BASEMENT FLOOR PLAN

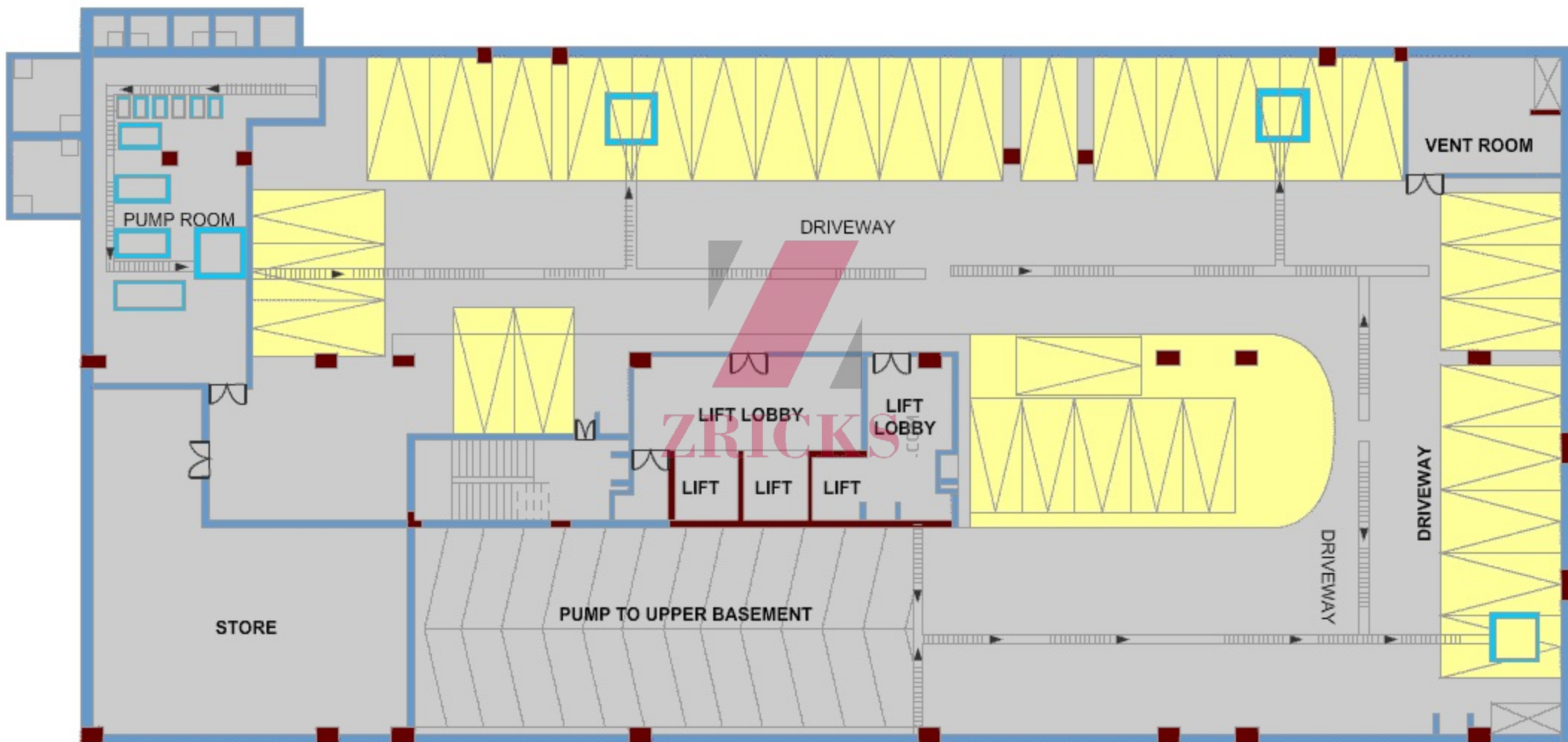

SECOND FLOOR PLAN

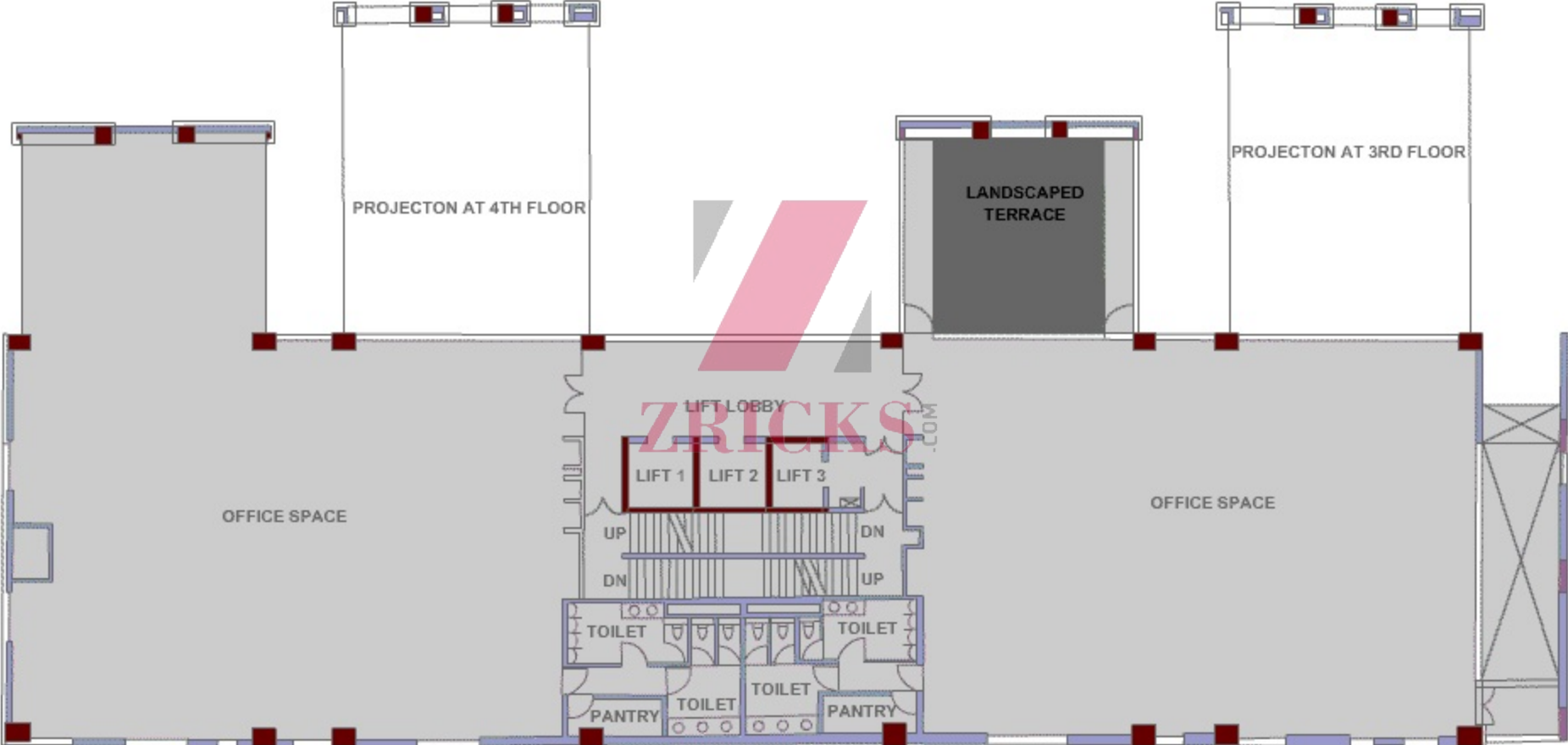

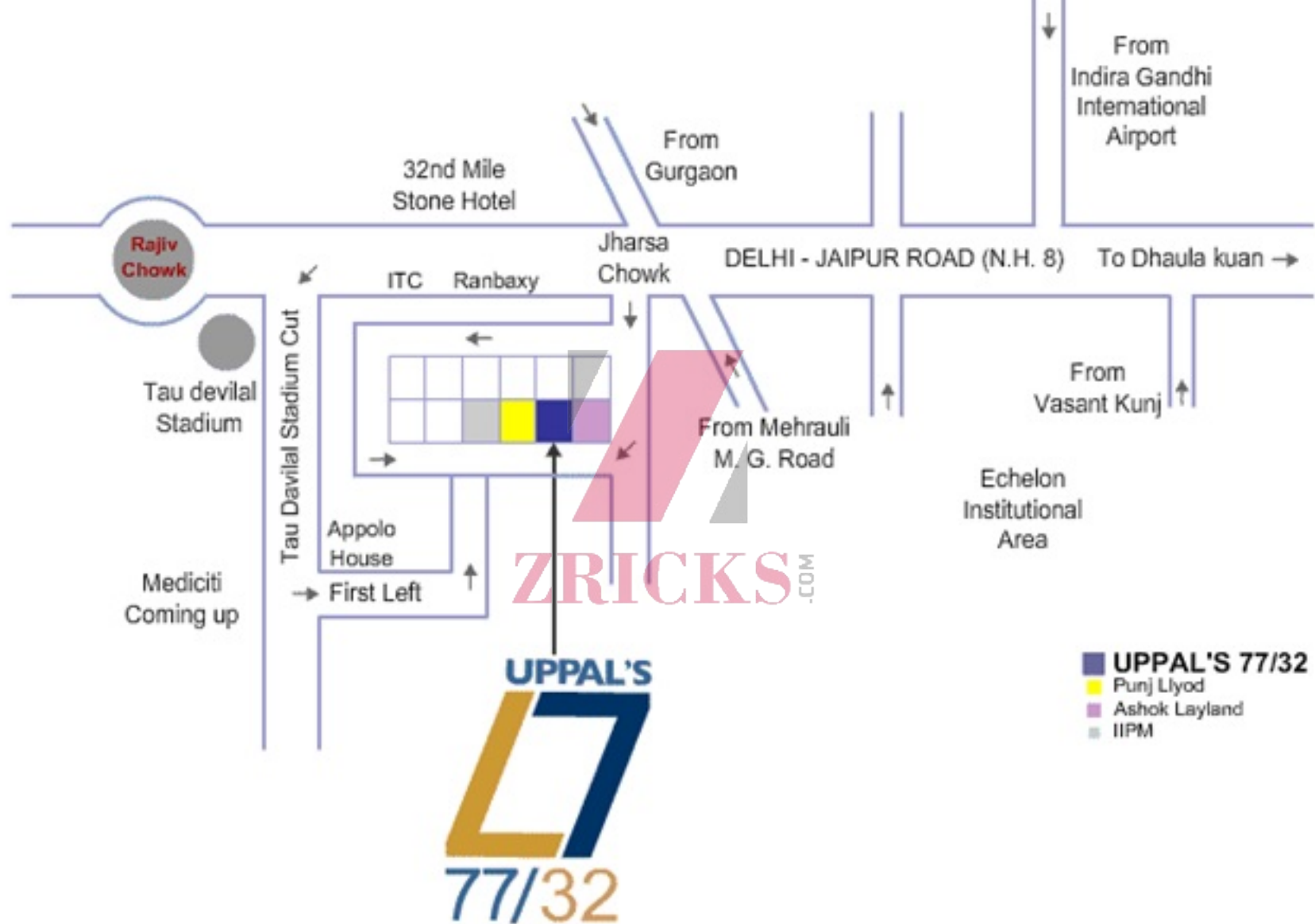

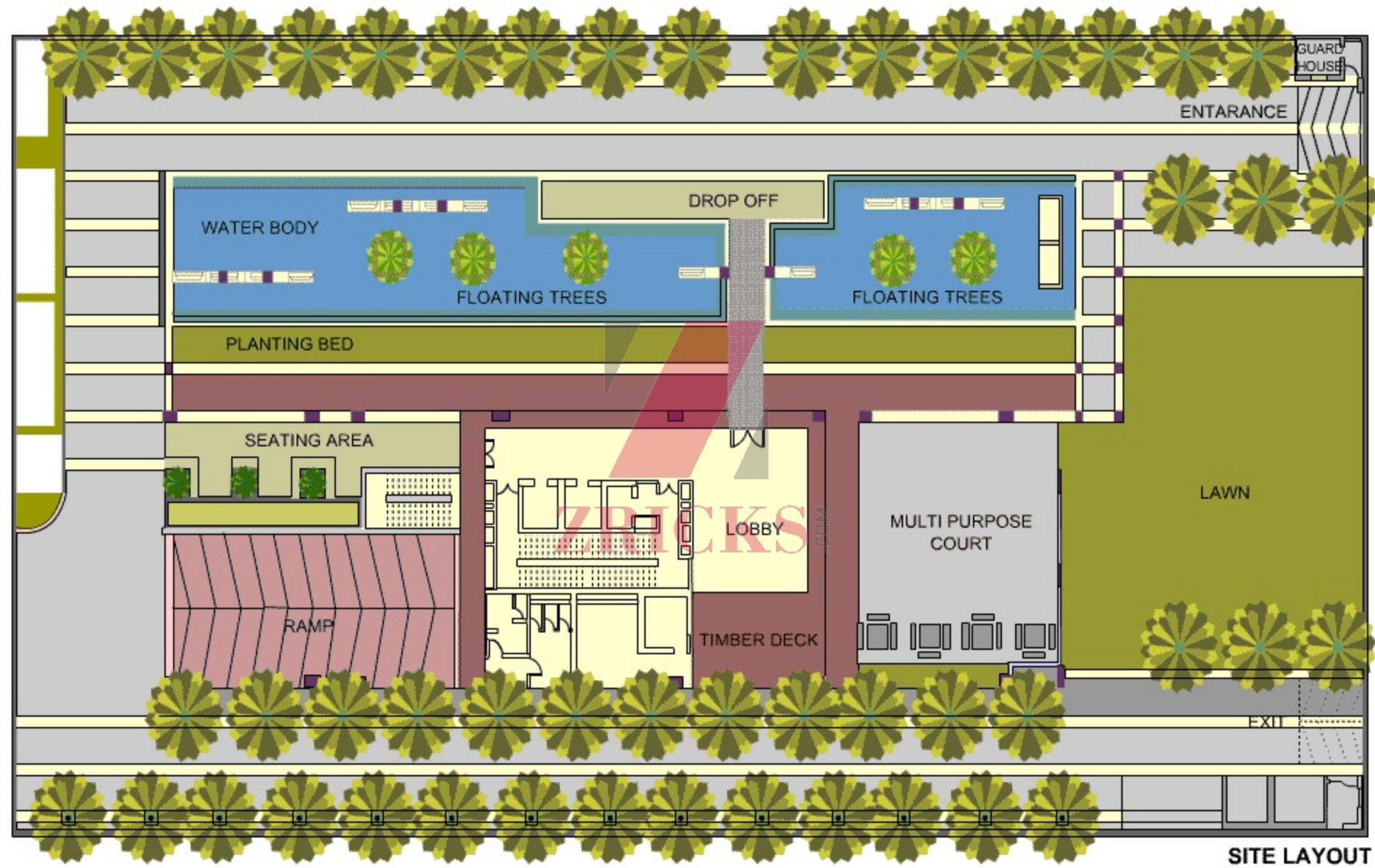

SITE LAYOUT



ZRICKS GROUP

A rendering of a new office building with a central atrium and skybridge connecting two main wings. The building is set against a clear blue sky with a few wispy clouds. In the foreground, there is a green lawn with several young trees and a paved walkway. A few people are visible walking on the path, and a dark car is parked on the right.



ZRICKS MOD.



ZRICKS CON

