

# For a better quality of life

'Sumadhura's Silver Ripples' is a project of Sumadhura Infracon – a team with the vision and imagination it takes to create a project that answers every modern requirement while maintaining a holistic way of life. Sumadhura Infracon is defined by professionalism and expertise; right from the acquisition of land, appointment of architects and designers, to the construction and delivery of projects on-time, sales and after sales service. Today the Company is at the forefront of Bengaluru's construction and real estate arena.

Promoters:



No.43, C.K.B. Plaza, 2nd floor, Above Axis Bank, Marathahalli, Bengaluru - 37  
Ph: 97438 53888, 97438 51222, E-mail : silverripples@sumadhuragroup.com

url: [www.sumadhuragroup.com](http://www.sumadhuragroup.com)

Site:

Sy No. 25/1A, 25/2, 28, Borewell Road, Nellurahalli Village, K.R.Puram Hobli, Bengaluru - 560066

Architects  
Vernekar Associates Private Limited  
Architecture-Engineering-Interiors  
Koramangala, Bengaluru.  
[www.vernekar.in](http://www.vernekar.in)

Structural Engineers  
D.Srinivas & Associates  
Ph : 9845168681

Landscape Consultants  
Dhruva Landscape Architects  
Ph: 9845963401



Designed by FHMV (+91-9246542471) [www.fhmv.org](http://www.fhmv.org)

# life exalted

# You never knew life could be so vibrant



Take a journey off the beaten path and arrive at the gates of 'Sumadhura's Silver Ripples'. Float into an exotic landscaped gated enclave that your dreams have only scratched the surface of. Explore the limits of all that can be and of all that is still to come... and live the lifestyle that celebrates you as a person.

'Sumadhura's Silver Ripples' features 474 super luxury residential apartments spread over nine blocks, each consisting of a Cellar, Stilt and fourteen floors within a hi-rise gated community. Exquisitely detailed constructional features, water bodies, elaborate landscaping give the enclave the feeling of a woodland glen.

'Sumadhura's Silver Ripples' has been conceived for individuals who want more from life and even more from leisure. This is where time gently wafts by, bearing you on a cushiony cloud of luxury. And this is just the beginning ...



# Feel the poetry of the presentation

The plush exterior of 'Sumadhura's Silver Ripples' is a clear reflection of what lies within. The beauty of the facade is a curtain raiser to the symphony of perfection that awaits you.



# Put your feet up and relax for life is on song

When the world is run on electronics, why not your home? Convenience and comfort is yours, with the push of a button! At 'Silver Ripples' the latest technology is profitably harnessed not just for construction but also for your convenience and safety. The difference it makes to your life is amazing.

ZRICKS.COM

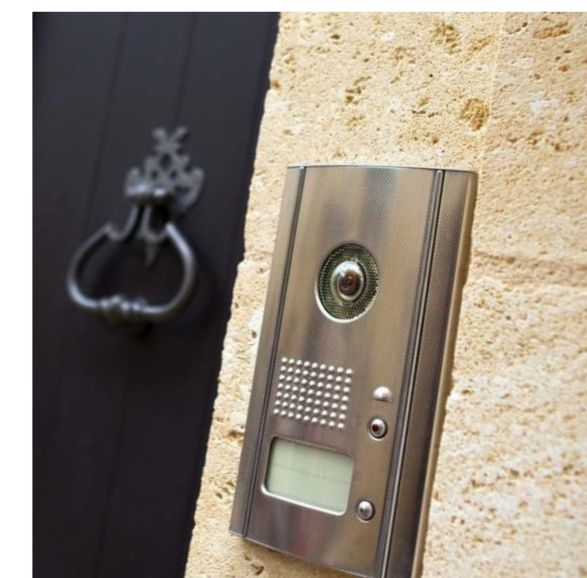

- ▶ **Wireless Controller**
- ▶ **Wireless Door Sensor (Intrusion Alert)**
- ▶ **Wireless lighting Control**
- ▶ **Video Door Bell**
- ▶ **Wireless AC and TV Control**
- ▶ **Video Intercom System Integrated to IPAD/ Android**
- ▶ **Wireless IR Station for TV and AC Control**
- ▶ **Wi-Fi enabled Audio/Video Intercom System with Touch Pad Control**
- ▶ **Flat to Flat Communication via Community Gateway**
- ▶ **Multi Tier Security:**  
Wireless Dual Switch Module Security Cabin, CCTV Surveillance, Solar fencing for entire compound, Firefighting equipment

Revel in the  
luxuriant ambience

# Get fit in body mind and soul

Happy living is not just about high style living. The efforts we made for providing fine living in every sense of the word will be evident from the leisure avenues provided. And fine living is an integrated approach that includes fitness, health, peace of mind and luxury. An indoor Squash court and a Badminton court help you keep fit and build up stamina. When it comes to indoor games, you have a difficult choice. Will it be Billiards or Table-tennis, chess or caroms or a host of other activities?

ZRICKS



- ▶ **Swimming pool and Toddlers Pool**
- ▶ **Air conditioned Multi Gym**
- ▶ **Indoor Squash Court**
- ▶ **Jacuzzi and Steam Bath**
- ▶ **Children's Play Area**
- ▶ **Indoor Shuttle Badminton Court**
- ▶ **Playground / Cricket Practice Pitches**
- ▶ **Sandpit with kids' play equipment, Climbing Walls and Synthetic Spider Nets**
- ▶ **Raised plaza with Giant chess**
- ▶ **Climbing wall ( For Elders)**
- ▶ **Basketball hoop**
- ▶ **Bicycle track with Cycle stands**

# Healthy body, healthy mind and happy living



Clean air, quiet and soothing surroundings, vast open areas, abundant greenery, choice plants and trees, all provided by design, to offer you well-deserved peace of mind and health benefits. Let us move on. There are separate exercise areas, rubber matted children's corner, a reflexology pathway, elder's plaza and many more.

Now we are happy. You have everything to foster your total well being.



- ▶ Elders' Plaza / Senior Citizen's Zone
- ▶ Reflexology Pathway
- ▶ OAT
- ▶ Stepped seater with Pergola
- ▶ Aroma / Butterfly garden
- ▶ Palm Court with seating
- ▶ Hopscotch
- ▶ Chalk Gallery
- ▶ Interactive Water Feature
- ▶ Jogging/Walking Path
- ▶ Party Lawn
- ▶ Pavilion with Food Counter
- ▶ Paved platform ( for Yoga / Laughter Club)
- ▶ Meditation Pavilions
- ▶ Activity Corner
- ▶ Skating Rink

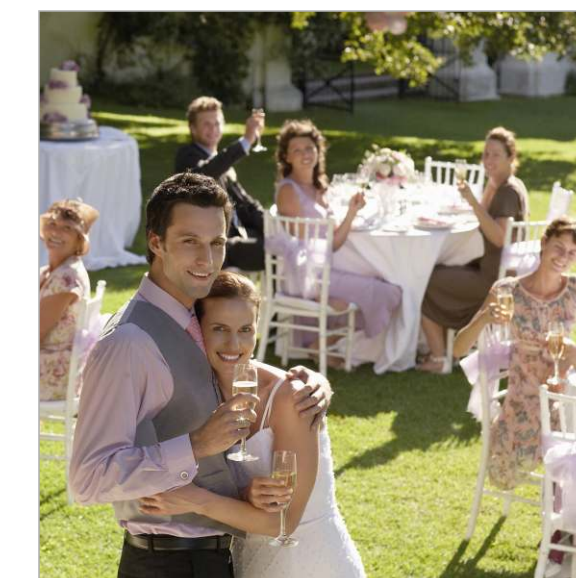



# Life at the crossroads of business and enterprise

Within the enclave there is peace and calm – an all enveloping tranquility. Outside there is growth and development. With leading corporate enterprises, shopping malls, religious shrines and business houses in the vicinity, 'Sumadhura's Silver Ripples' is at the confluence of progress.

## Location Plan

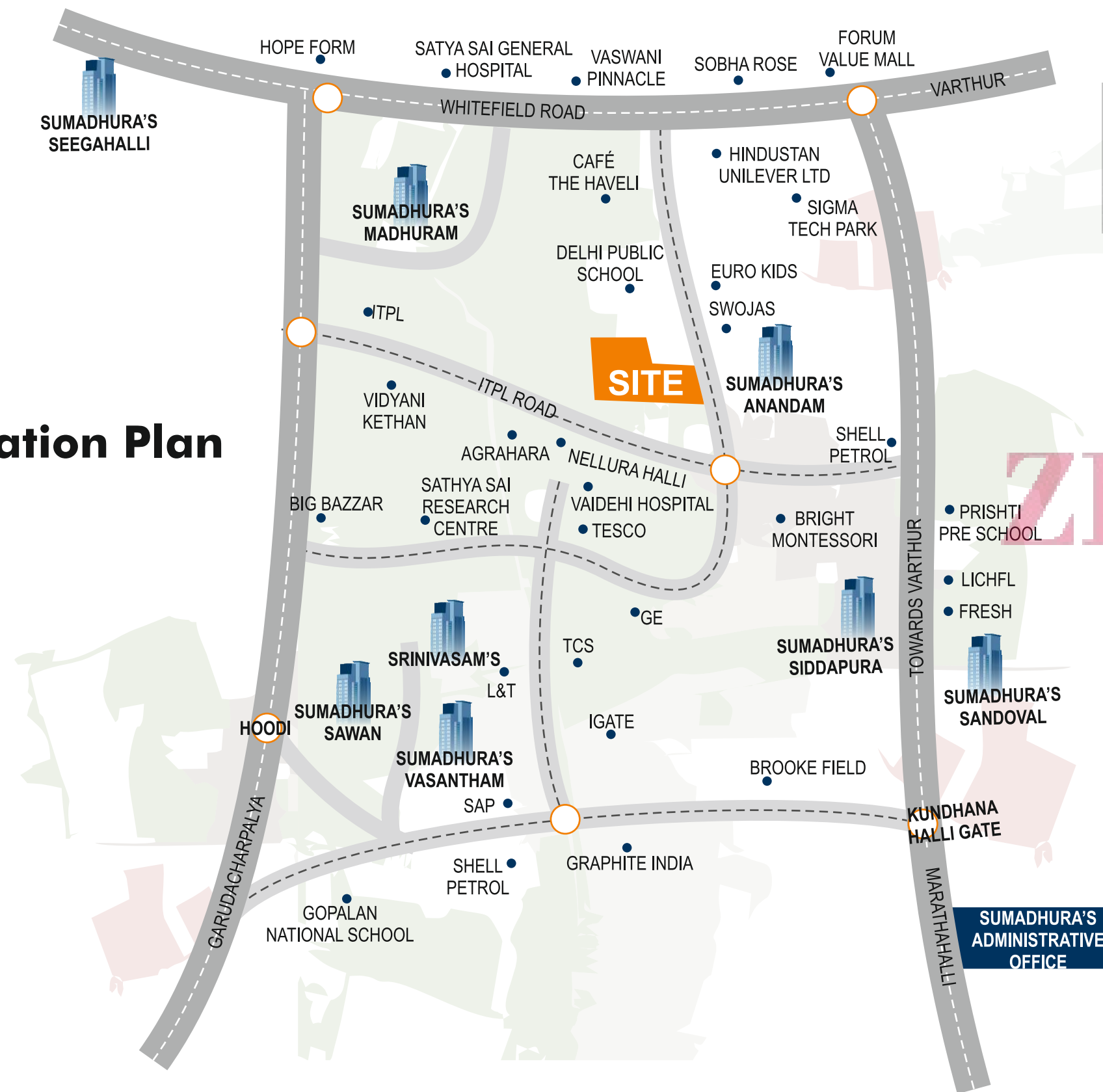

Phoenix Market City



Forum Value Mall

## Near to ...

### Educational Institutions

- Gopalan National School → 3.5 Km
- Euro School → 4 Km
- Ryan International School → 5 Km
- Vibgyor → 4 Km

### Health Care

- Vydehi Hospital → 2 Km
- Sai Baba Hospital → 2.5 Km
- Shankar Eye Hospital → 4 Km
- Yashomathi Hospital → 4 Km

### Hospitality

- Radha homotel → 3 Km
- Keys Hotel → 3.5 Km
- Fortune Hotel → 3 Km
- ZURI Hotel → 4 Km

### Malls

- The Forum Value Mall → 2 km
- Park Square → 3 km
- Phoenix City → 6 km

### Landmarks

- Sap Labs → 2.5 km
- GE → 1.7 km
- TCS → 2 km
- ITPL → 1.5 km
- Tesco → 2 km
- Capgemini → 2 km



# life resplendent and vibrant

Layout Plan

**BBMP APPROVED**  
BRUHAT BENGALURU MAHANAGARA PALIKE APPROVED

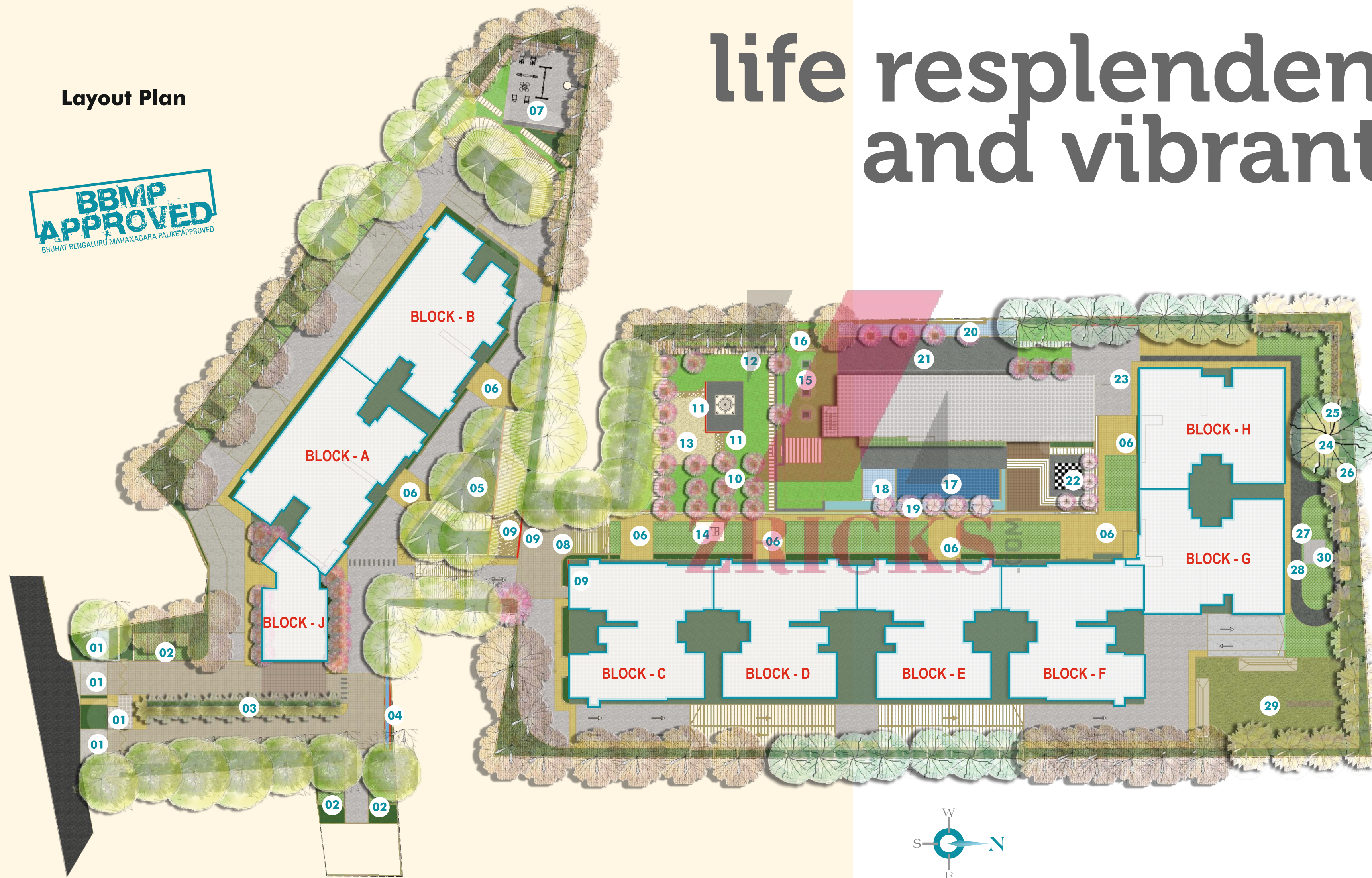

- 01 ENTRY/EXIT WITH SECURITY KIOSK & ENTRANCE GATEWAY
- 02 CAR PARKING LOTS
- 03 PALM BOULEVARD
- 04 FRAME WALL WITH WATER FEATURE
- 05 CUTOUT WITH TREES
- 06 ENTRIES TO BLOCKS
- 07 CHILDRENS PLAY / BASKETBALL HOOP
- 08 CENTRAL PLAZA
- 09 FEATURE WALL
- 10 TREE COURT WITH SEATING PLAZA
- 11 CLIMBING WALLS
- 12 OAT WITH STAGE
- 13 SANDPIT WITH SYNTHETIC SPIDER NETS
- 14 HOPSCOTCH COURT
- 15 PARTY LAWN
- 16 PAVILION WITH FOOD COUNTER
- 17 ADULTS' POOL
- 18 KIDS' POOL
- 19 VANISHING EDGE WITH TREE PLANTERS
- 20 WATER FEATURE WITH WEEPING WALLS
- 21 OUTDOOR SPILLOVER AREA
- 22 RAISED PLAZA WITH GIANT CHESS
- 23 SKATING RINK
- 24 ELDERS' ZONE
- 25 MEDITATION PAVILION
- 26 YOGA PLATFORM
- 27 BICYCLE TRACK
- 28 JOGGING/WALKING PATH
- 29 CRICKET PITCHES/PLAYGROUND
- 30 CHALK GALLERY

# Typical Floor Plan: Block-A



Isometric view - 2.5 BHK



Isometric view - 3 BHK



## Area Statement Block A

| Flat No     | Type    | Area in Sft |
|-------------|---------|-------------|
| 201 to 1401 | 3BHK    | 1805        |
| 202 to 1402 | 3.5BHK  | 2155        |
| 203 to 1403 | 3BHK    | 1805        |
| 204 to 1404 | 2.5 BHK | 1585        |

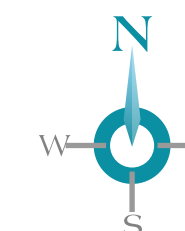

## Key Plan Block-A

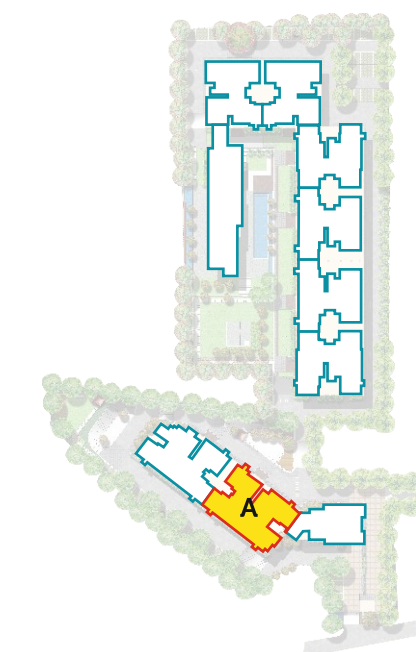

ZBRICKS.COM

# Typical Floor Plan: Block-B

Isometric view - 3.5 BHK



Key Plan Block-B

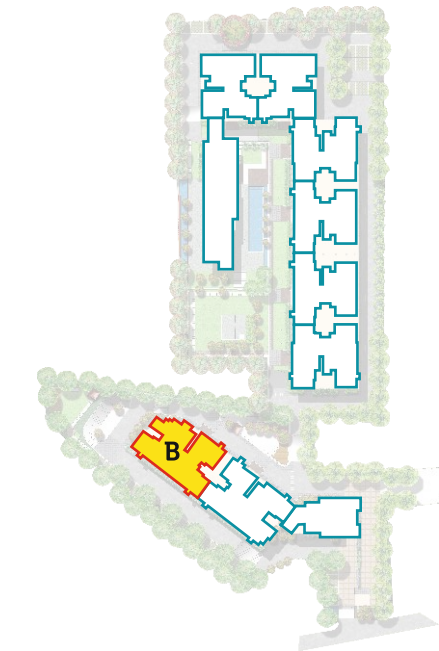

Area Statement Block B

| Flat No     | Type   | Area in Sft |
|-------------|--------|-------------|
| 201 to 1401 | 2.5BHK | 1585        |
| 202 to 1402 | 3BHK   | 1805        |
| 203 to 1403 | 3.5BHK | 2150        |
| 204 to 1404 | 2BHK   | 1300        |



## Typical Floor Plan: Block-C

## Typical Floor Plan: Block-D



### Area Statement Block C

| Flat No     | Type | Area in Sft |
|-------------|------|-------------|
| 201 to 1401 | 2BHK | 1340        |
| 202 to 1402 | 2BHK | 1340        |
| 203 to 1403 | 3BHK | 1805        |
| 204 to 1404 | 3BHK | 1805        |

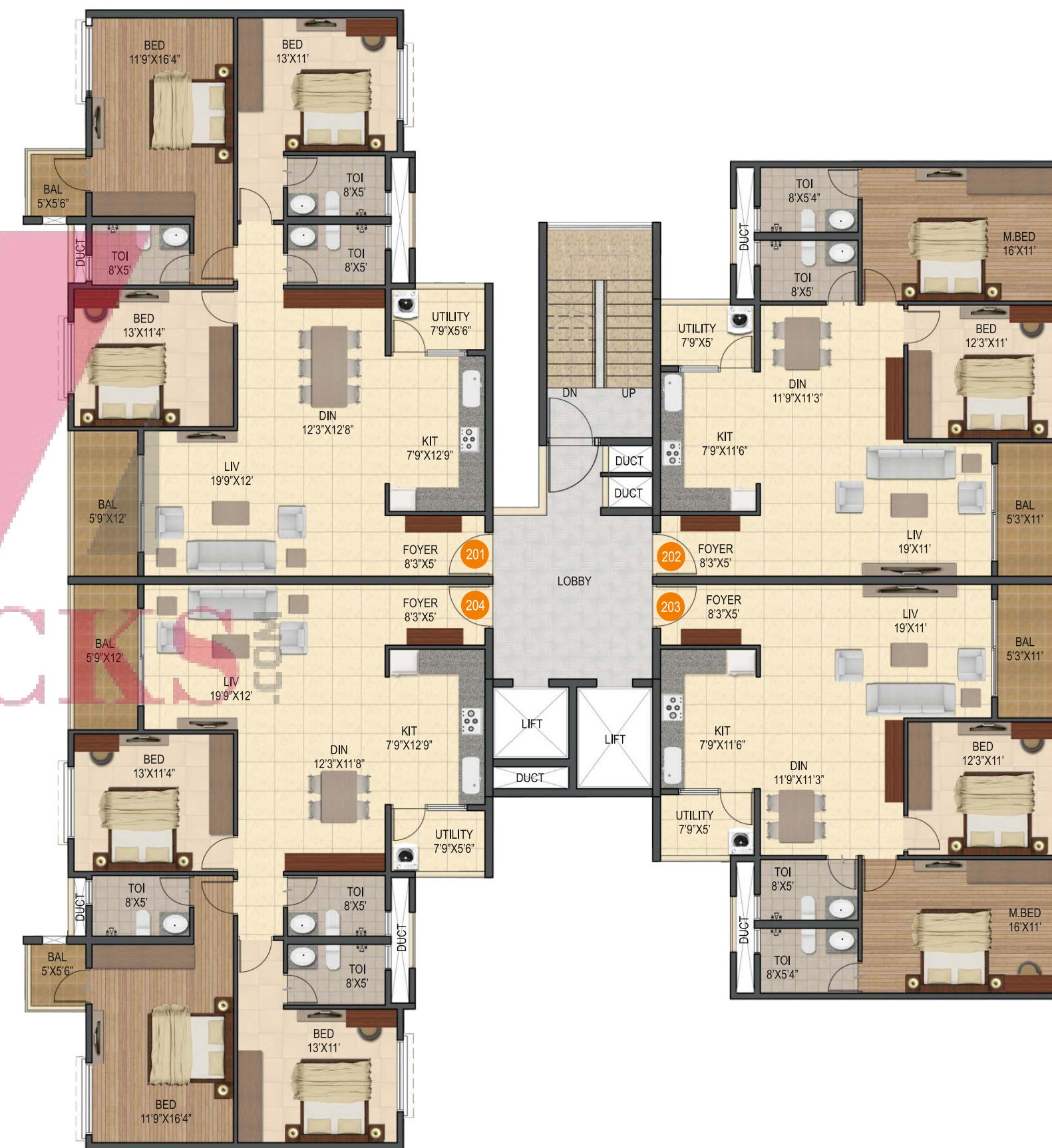

### Area Statement Block D

| Flat No     | Type | Area in Sft |
|-------------|------|-------------|
| 201 to 1401 | 3BHK | 1805        |
| 202 to 1402 | 2BHK | 1320        |
| 203 to 1403 | 2BHK | 1320        |
| 204 to 1404 | 3BHK | 1805        |

ZRICKS.COM

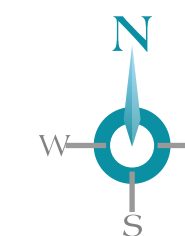

### Key Plan Block-C&D

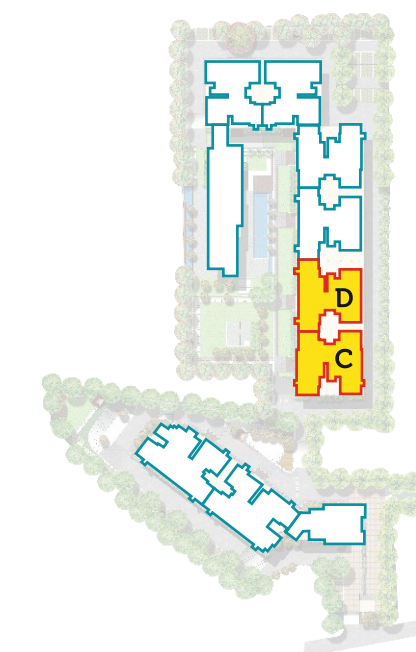

## Typical Floor Plan: Block-E



### Area Statement Block E

| Flat No     | Type | Area in Sft |
|-------------|------|-------------|
| 201 to 1401 | 3BHK | 1805        |
| 202 to 1402 | 2BHK | 1320        |
| 203 to 1403 | 2BHK | 1320        |
| 204 to 1404 | 3BHK | 1805        |

## Typical Floor Plan: Block-F



### Area Statement Block F

| Flat No     | Type | Area in Sft |
|-------------|------|-------------|
| 201 to 1401 | 3BHK | 1805        |
| 202 to 1402 | 3BHK | 1805        |
| 203 to 1403 | 2BHK | 1340        |
| 204 to 1404 | 2BHK | 1340        |

ZRICKS

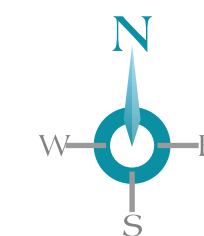

### Key Plan Block-E&F



## Typical Floor Plan: Block-G

## Typical Floor Plan: Block-H



### Area Statement Block G

| Flat No     | Type   | Area in Sft |
|-------------|--------|-------------|
| 201 to 1401 | 2.5BHK | 1585        |
| 202 to 1402 | 2BHK   | 1320        |
| 203 to 1403 | 2BHK   | 1285        |
| 204 to 1404 | 2BHK   | 1320        |



### Area Statement Block H

| Flat No     | Type   | Area in Sft |
|-------------|--------|-------------|
| 201 to 1401 | 2BHK   | 1320        |
| 202 to 1402 | 2BHK   | 1285        |
| 203 to 1403 | 2BHK   | 1320        |
| 204 to 1404 | 2.5BHK | 1585        |

ZRICKS.COM

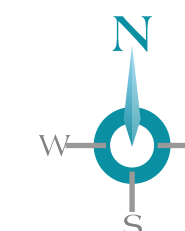

### Key Plan Block-G&H

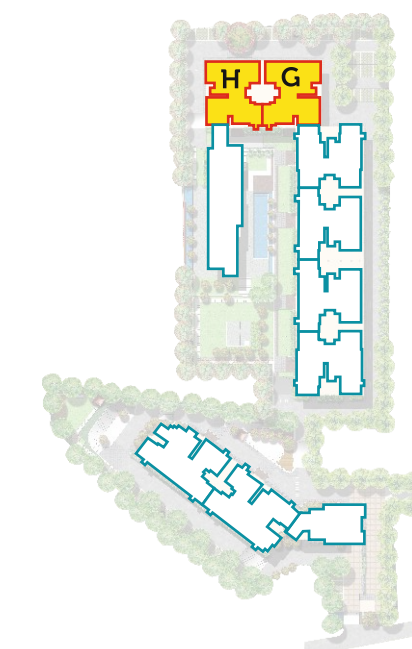

# Typical Floor Plan: Block-J

Isometric view - 3 BHK

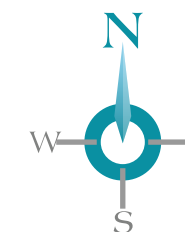

Key Plan Block-J

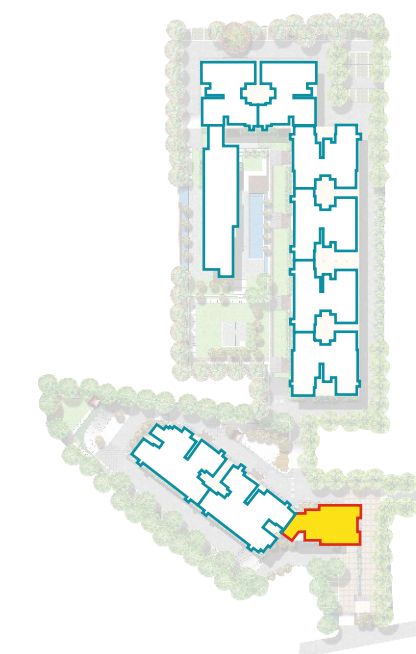

Isometric view - 2 BHK



### Area Statement Block J

| Flat No     | Type | Area in Sft |
|-------------|------|-------------|
| 201 to 1401 | 3BHK | 1900        |
| 202 to 1402 | 3BHK | 1900        |

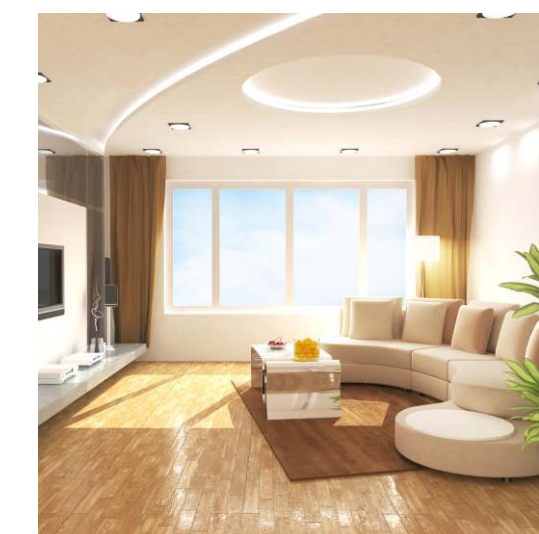



# Where the upper crust unwind

ZRICKS.COM

Presented here are 'Sumadhura's Silver Ripples' clubhouse features.

## Silver Ripples

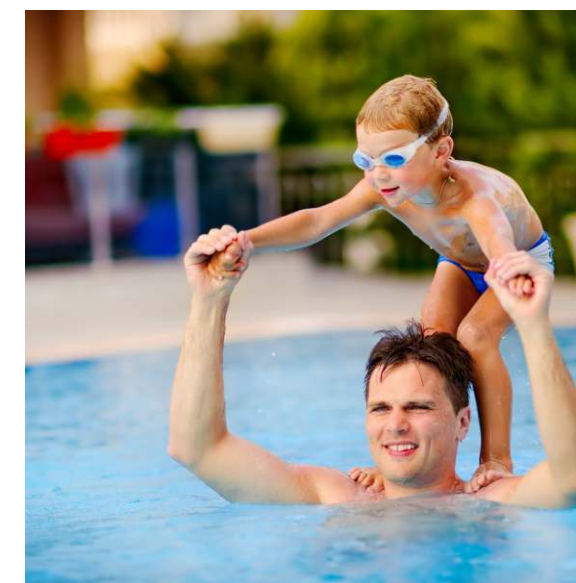

### Club House features:

- ▶ Swimming pool – Adults' & Kids' pool –with vanishing edge
- ▶ Children's play area with rubber matting
- ▶ Well equipped air conditioned Gymnasium
- ▶ Indoor games like Carom, Chess, Billiards, Table-Tennis
- ▶ Jacuzzi / Steam Bath
- ▶ Community Hall
- ▶ Open spillover Club area
- ▶ Squash Court
- ▶ A host of other indoor activities
- ▶ Shuttle Badminton Court

Forget the busy day. This is your own space and time. Indulge your passion. Sweat it out in the air-conditioned Gym! Chill out at the swimming pool. Watch your kids have fun in the toddlers' pool or go wild in their own special play area. Get competitive at Carrom, Chess, Billiards or Table Tennis, or take time to relax and rejuvenate at the Sauna, Jacuzzi or Steam Bath.



# Elaborately equipped and designed to please



## Specifications

### STRUCTURE

RCC framed structure with Seismic compliance as per IS code, solid block masonry for internal and external walls.

### DOORS & WINDOWS

Main door in Teak Wood frame, all other door frames in non teak wood and total paneled skin shutters with one side polish and one side enamel paint. Good quality of hardware for all doors. UPVC sliding windows with glass and MS Grills. Provision for Mosquito Shutter

### FLOORING

Wooden flooring for Master Bedroom and Vitrified tiles for all other areas. Ceramic tiles for balconies.

### KITCHEN

Black Granite kitchen Platform, stainless steel sink with drain board, 2 feet dado above granite kitchen platform in digital print ceramic glazed tiles.

### ELECTRICAL

Fire resistant wires and elegant modular switches of Havells/ Northwest or Equivalent. 3 KW power will be provided for each flat. Standby Generator for common areas and power back up of ONE KVA for each flat.

### TOILETS

Digital Ceramic glazed tiles dado up-to 7' height in bathroom. White sanitary ware of Hindware/ Cera/ RAK or equivalent make in all toilets. Hot and cold water mixer unit of JAQUAR or equivalent make, for shower in all the toilets. Health faucet for all toilets. Concealed master control cock in every toilets.

### PAINTING

Interior-surfaces - Plastic Emulsion Paint. Exterior-surfaces - water proof cement paint. Enamel paint for MS grill. Melamine polish for teak surfaces.

### RAINWATER HARVESTING

Shall be an integral part of the ecology management system.



**Come, discover  
the most beautiful place to live ...**